

3mm ply, Motor mount elements  
("MotorMountSides", "MotorMountFront")

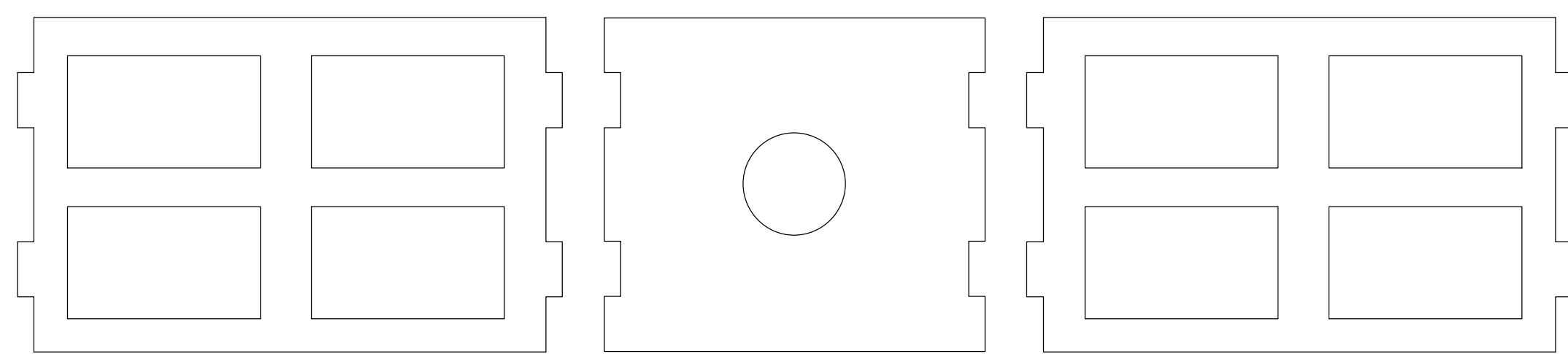

Balsa, 2mm thick ("Hatch Plane")

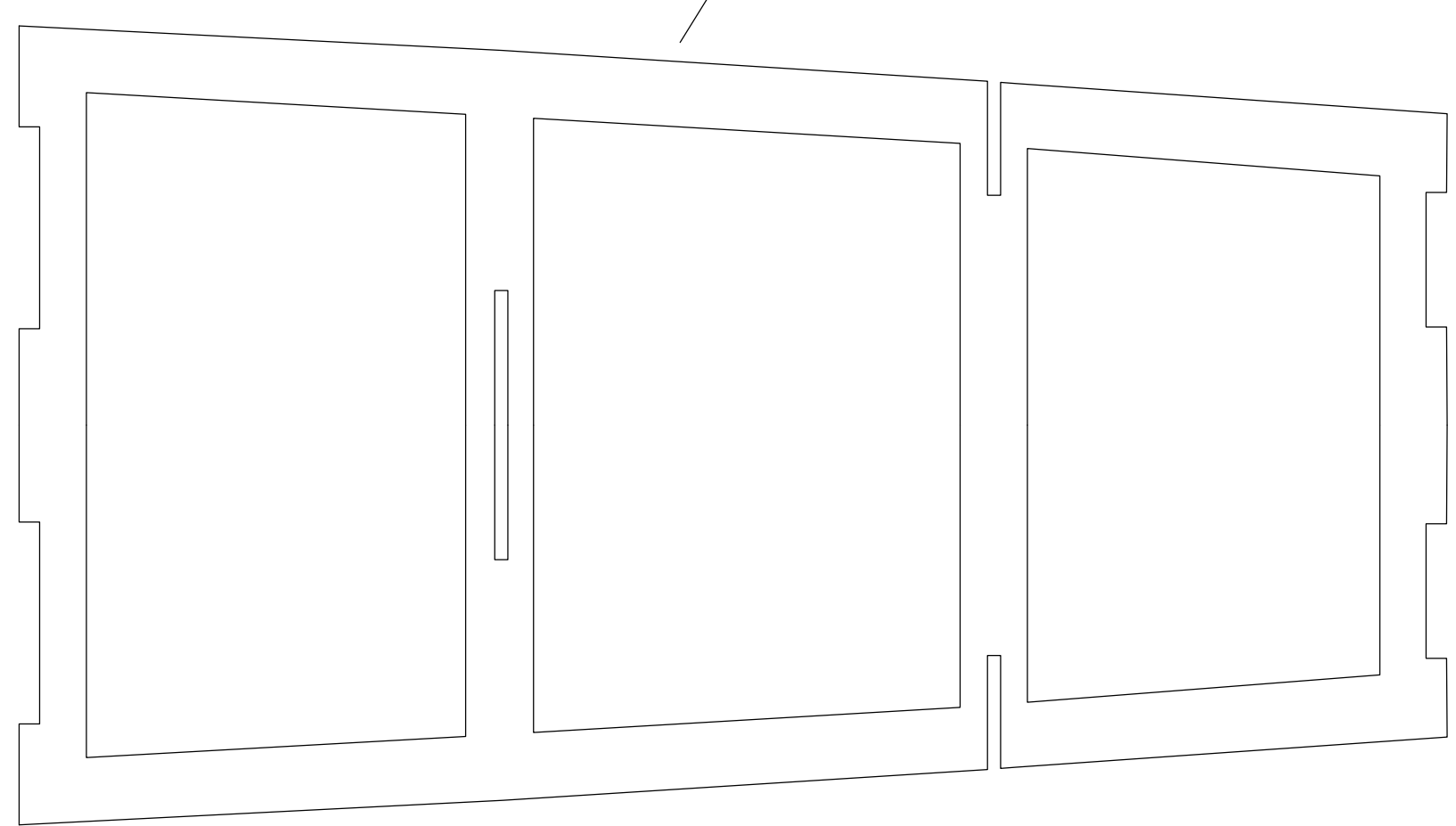

Ply, 2mm ("FuselageSides")

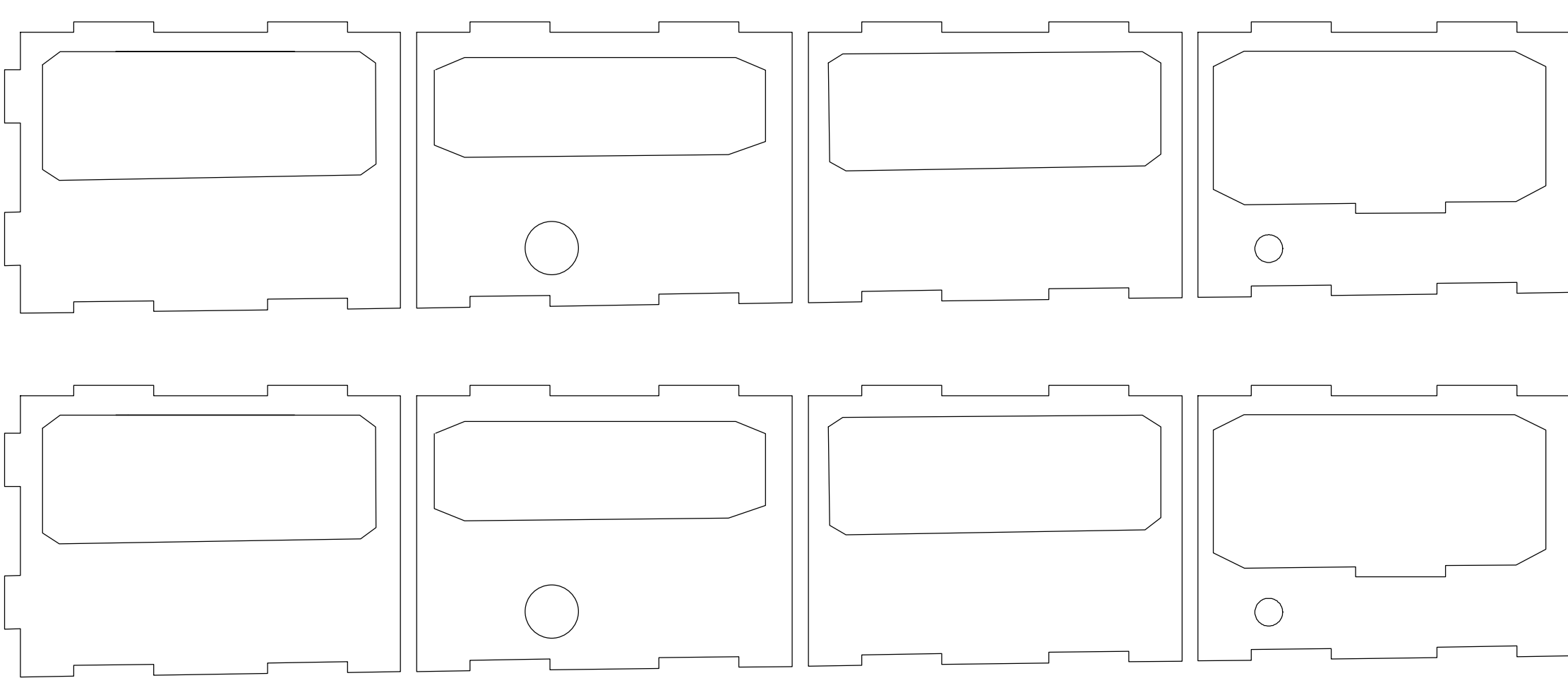

Maybe make this one longer?

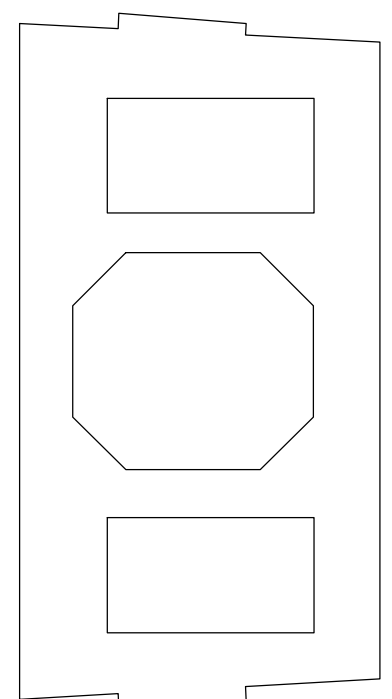

Ply, 2mm ("FuselageServoMount")

Ply, 2mm ("BottomPlane")

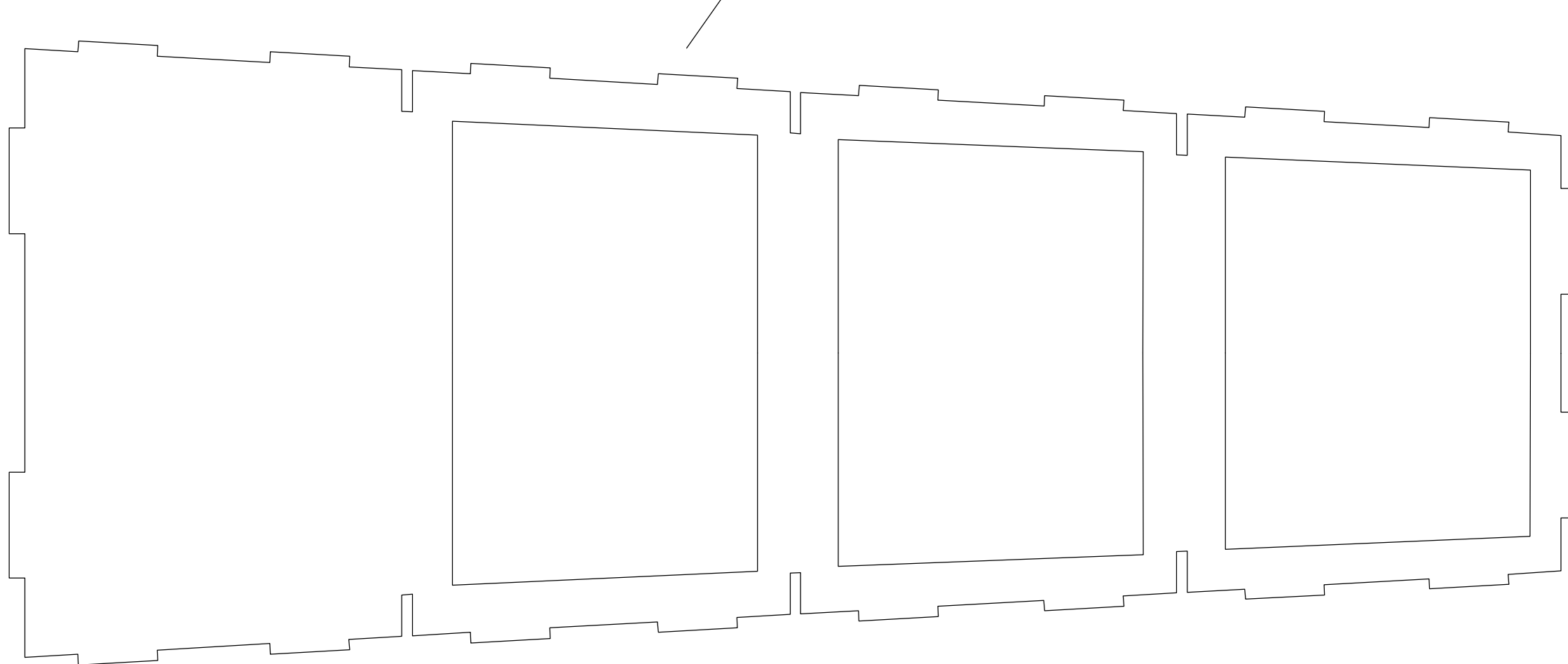

Ply, 3mm thick ("Former1 1.001")

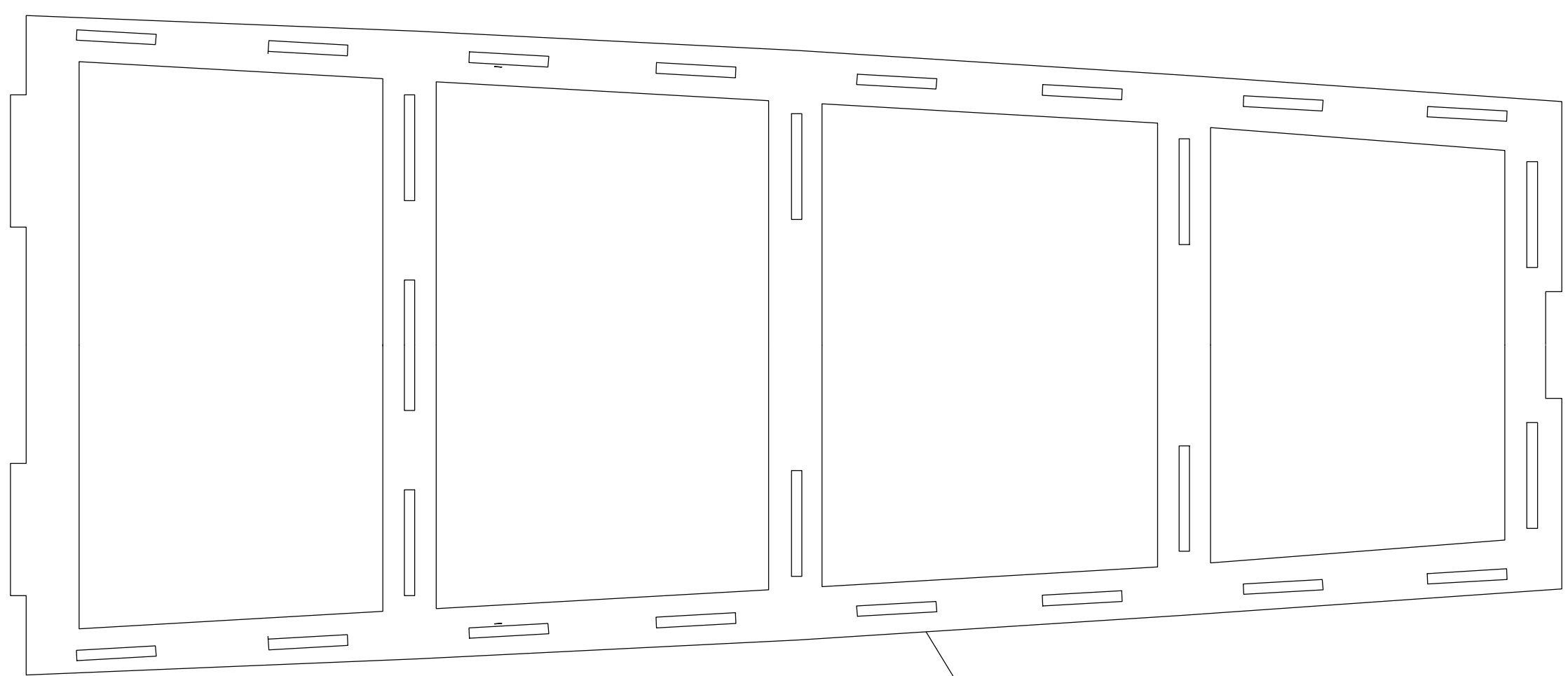
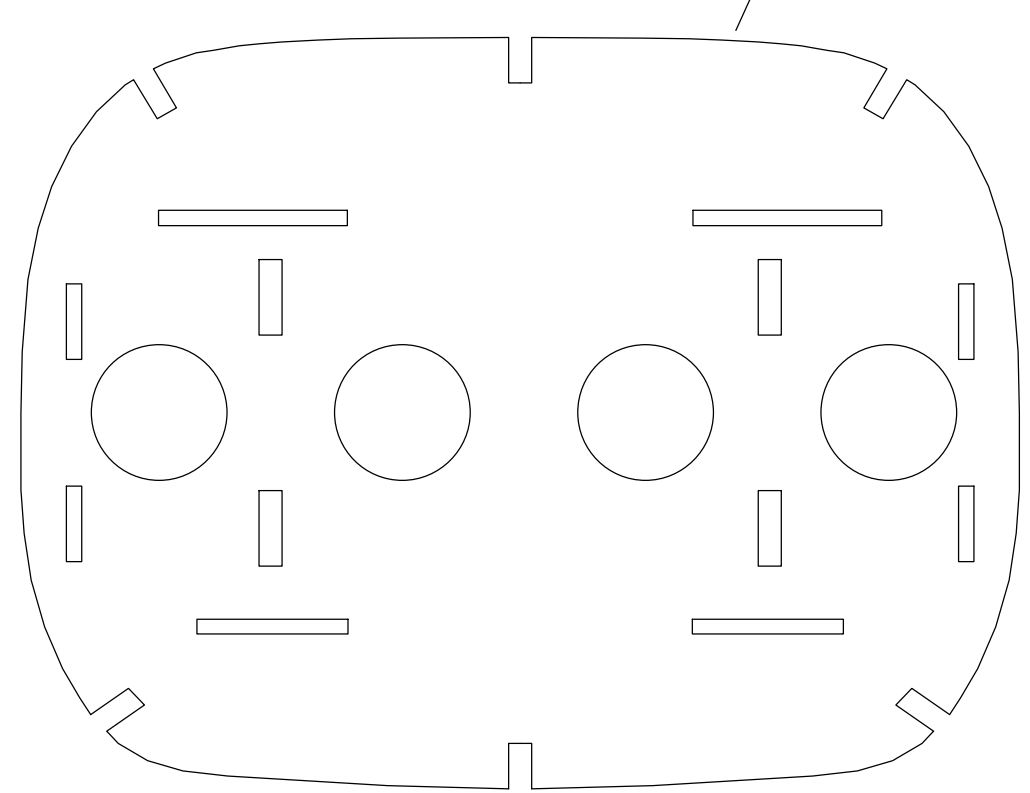

Ply, 2mm thick ("Main Plane")

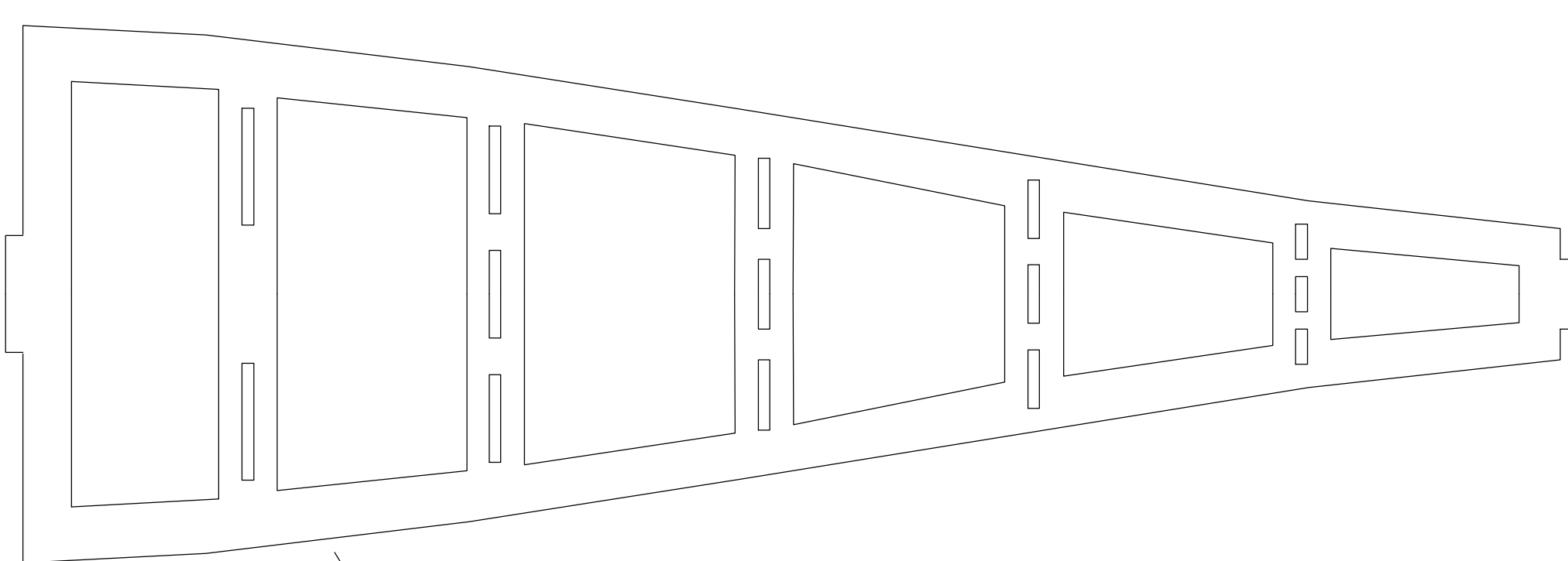

Balsa, 2mm thick ("Main Plane Aft")

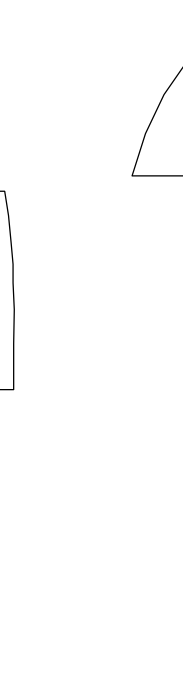
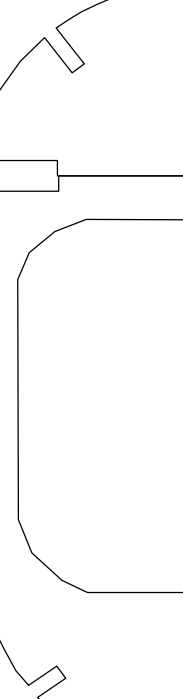
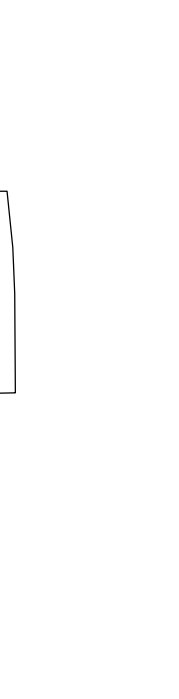
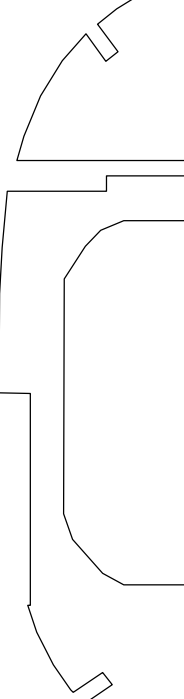
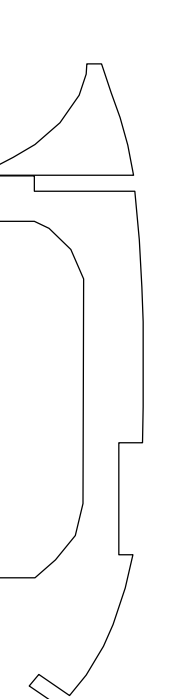
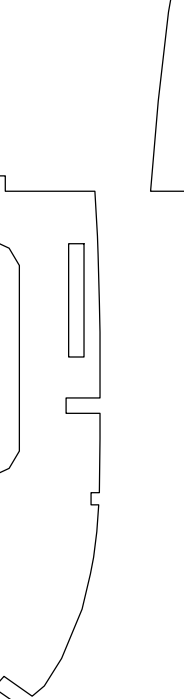
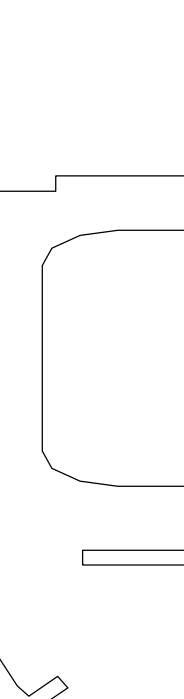
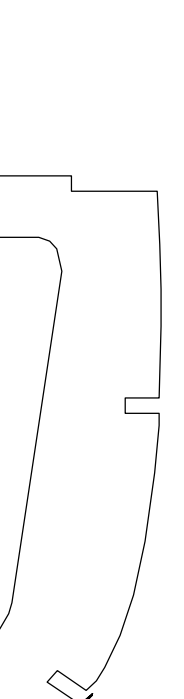
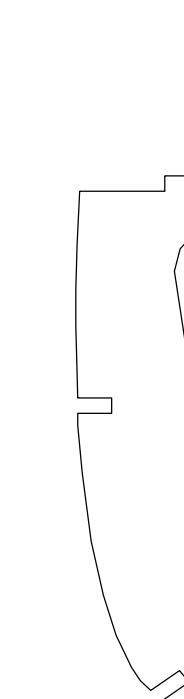
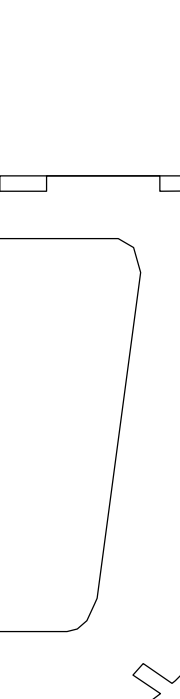
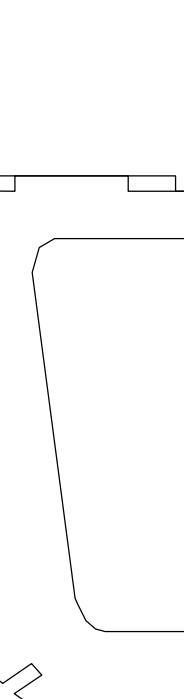
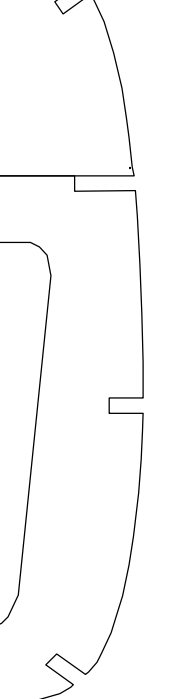
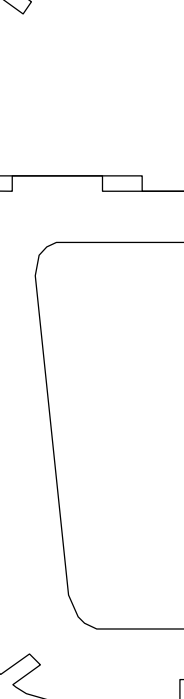
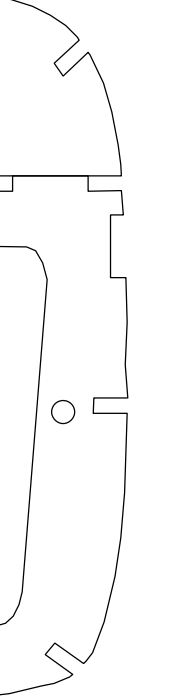
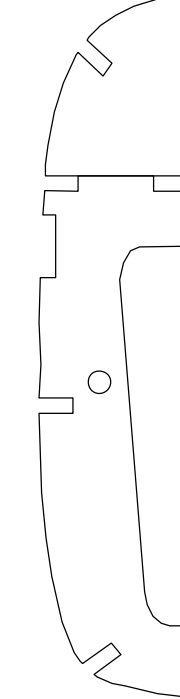
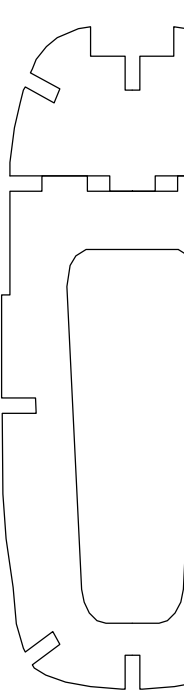
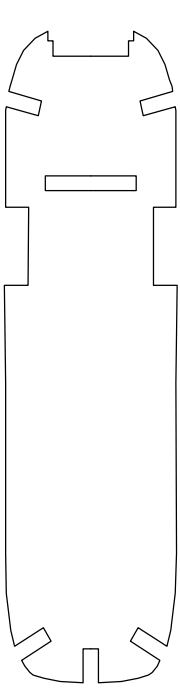
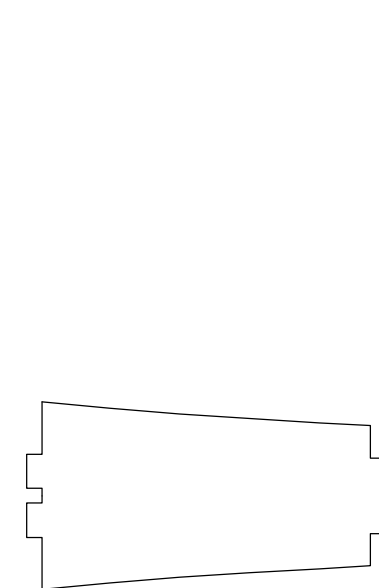
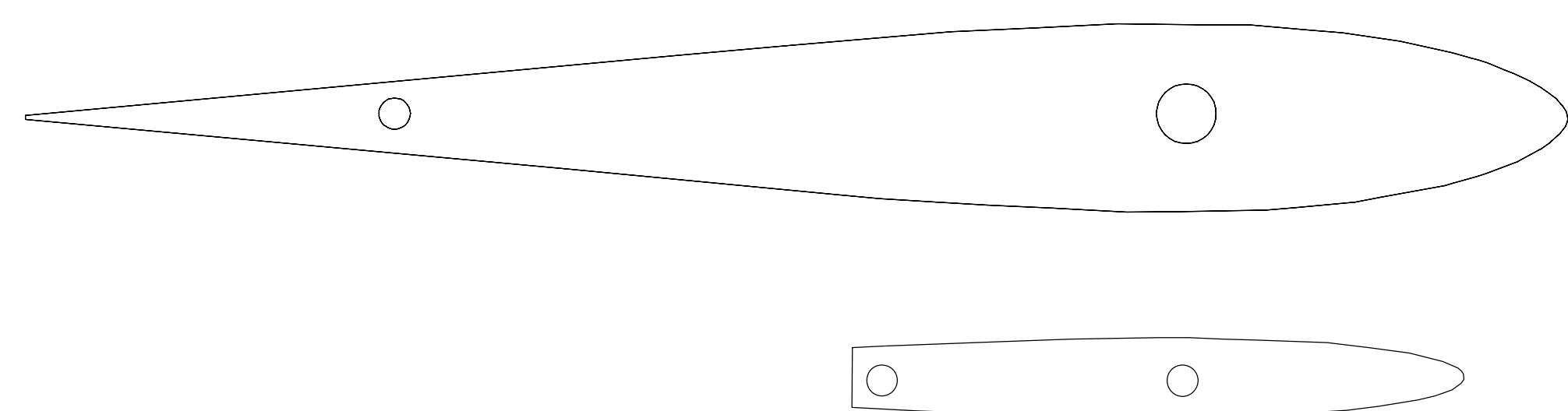

Light balsa, 2mm thick ("HatchFrontFormer.002")

Light balsa, 2mm thick ("Former 10.001")

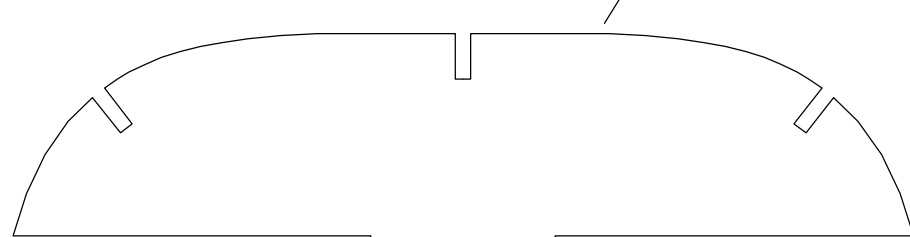

<http://www.xtremeair.com/en/XA-Aircraft/XA41/Specification>

[https://www.flyingfoam.com/content/what-airfoil-should-i-use-0:](https://www.flyingfoam.com/content/what-airfoil-should-i-use-0)

BEST FOR WING (symmetrical, 12.45%): E168

BEST FOR STABS (symmetrical, thinner): NACA0008 (8%). Or flat???

From left to right: fuselage formers, as defined  
in the accomanied blender file, from back to front.  
All balsa, 2mm.