

Wing  
Make 1

4

2

0

2

**Scale in inch**

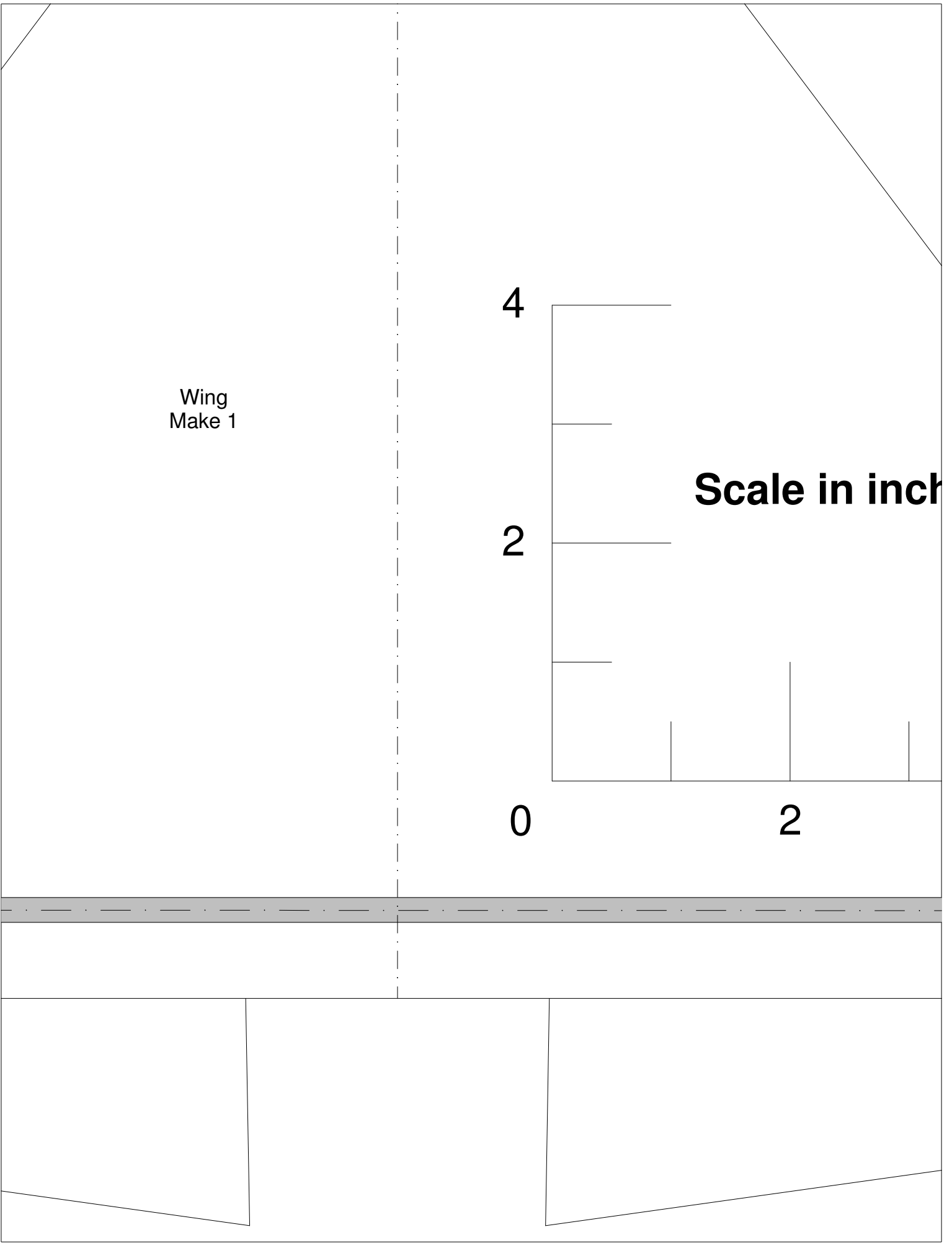

nes

4

Vertical tail  
Make 1

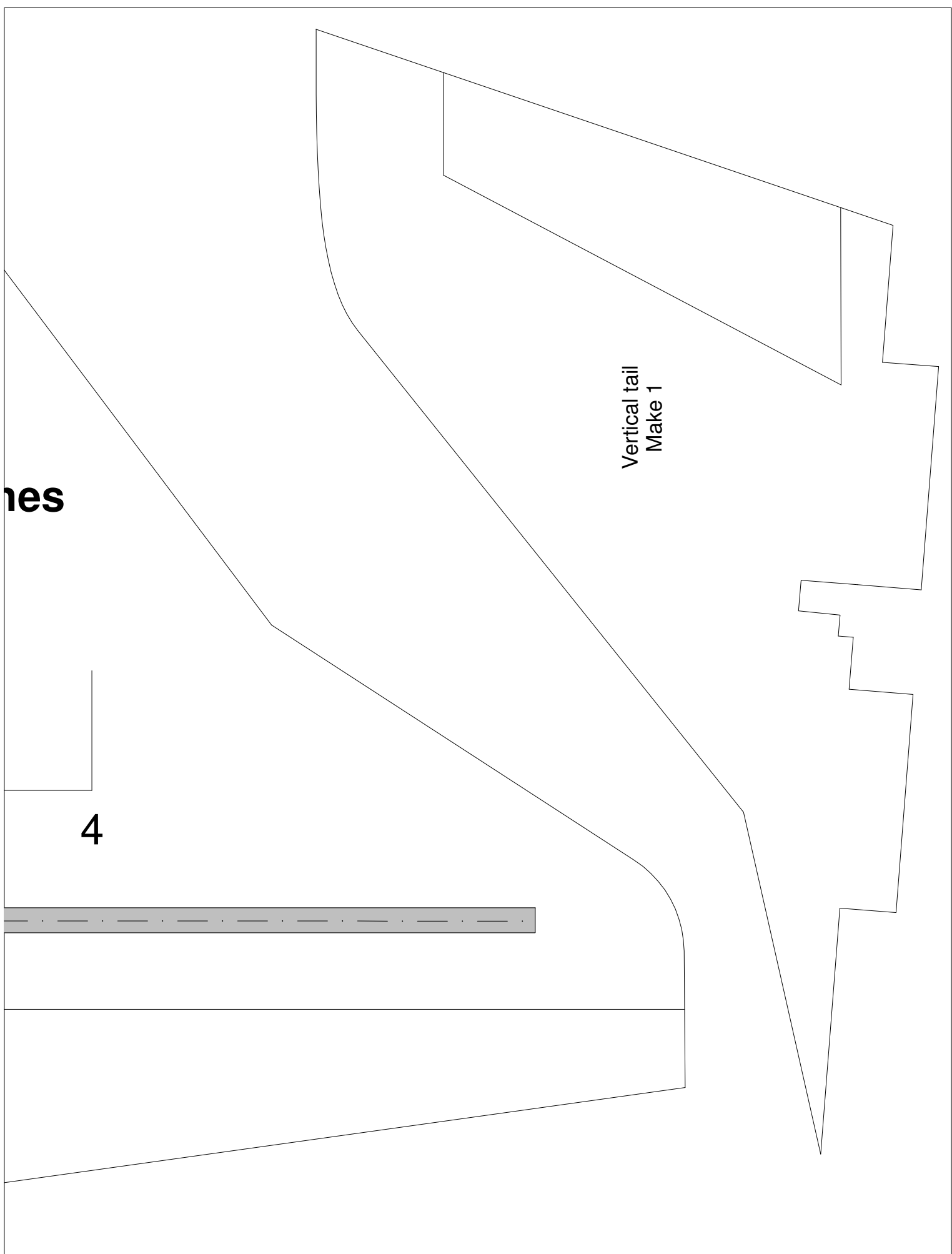

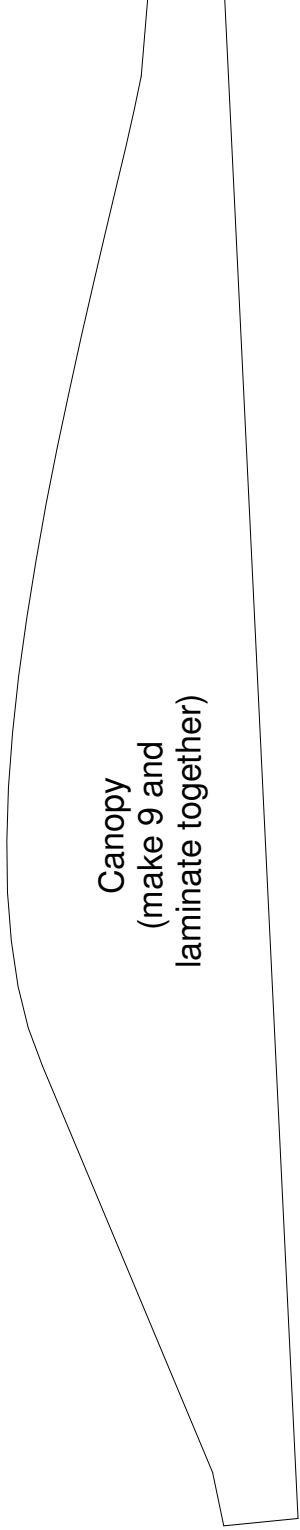

Canopy  
(make 9 and  
laminated together)

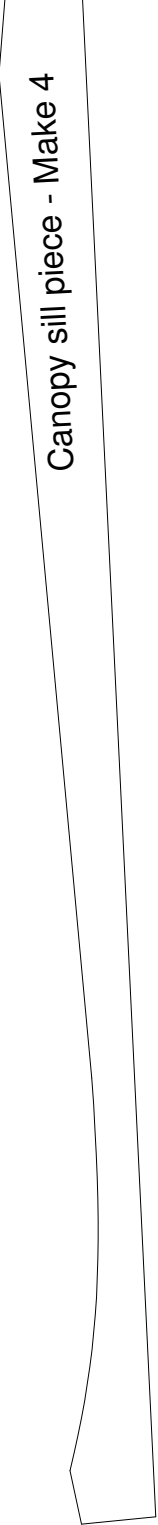

Canopy sill piece - Make 4

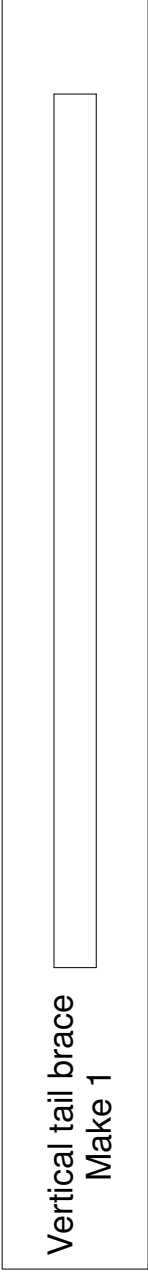

Vertical tail brace  
Make 1

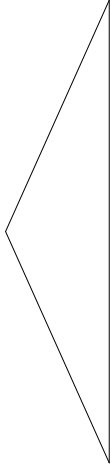

Inlet diverter  
Make 1, 1/16" balsa



Inlet front top  
Make 1, 1/32" ply

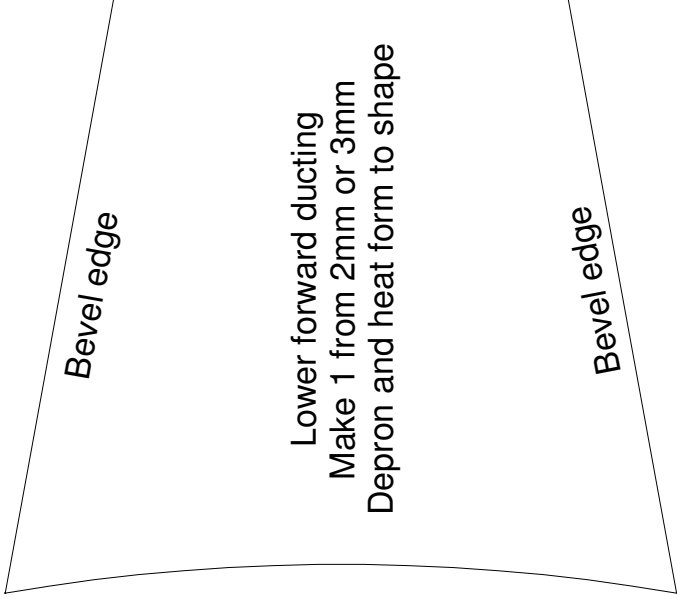

Bevel edge

Lower forward ducting  
Make 1 from 2mm or 3mm  
Depron and heat form to shape

Bevel edge

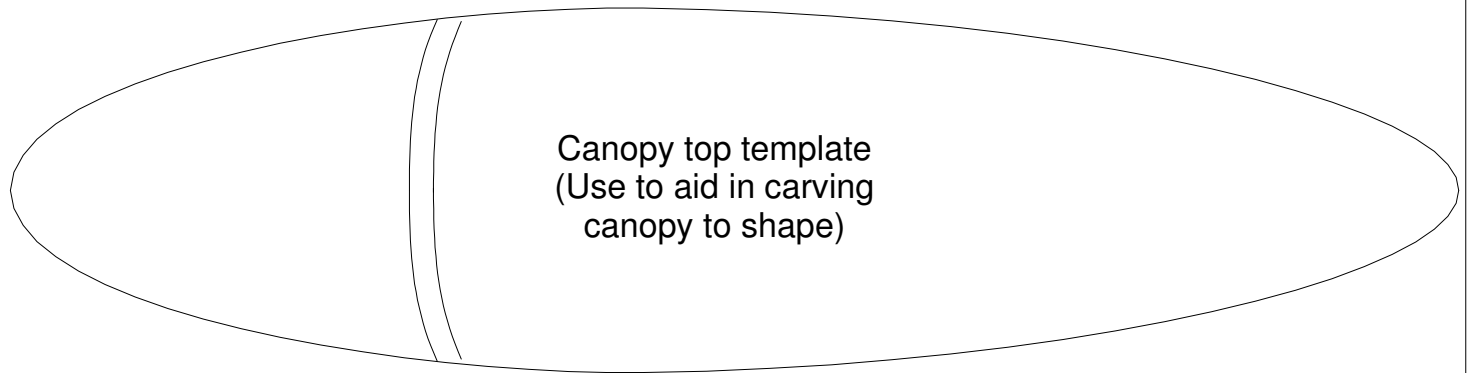

Rudder

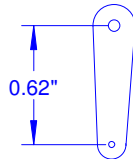

Elevator

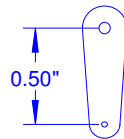

Vane control arms  
Make 1 each from  
1/16" ply

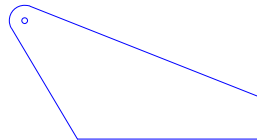

Elevon control arms  
Make 2 from 1/32" ply

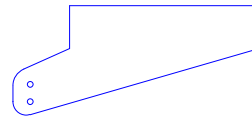

Rudder control arm  
Make 1 from 1/32" ply

**All parts made from 6 mm Depron or  
BlueCore foam unless otherwise specified**

***X-31 Park Jet EDF***  
***Designed and drawn by Steve Shumate***  
***Copyright © 2006 All Rights Reserved***

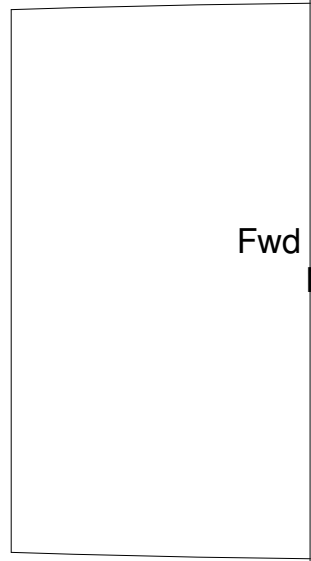
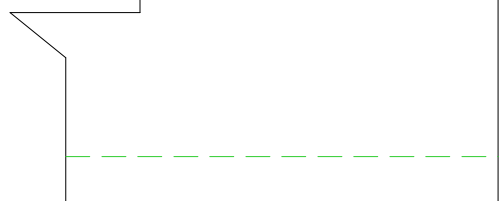
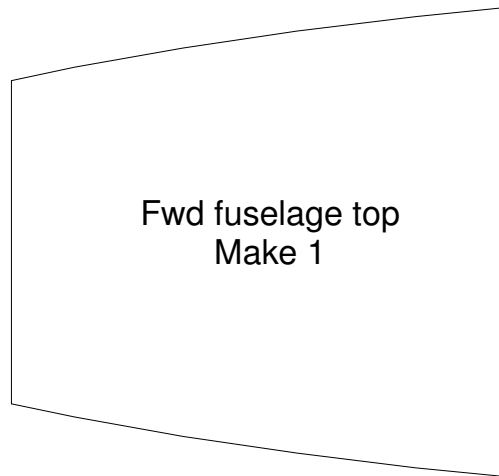
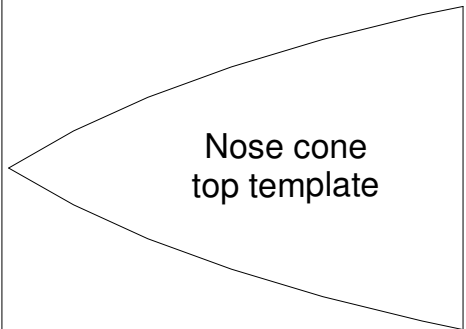
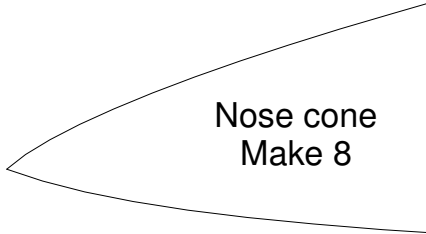
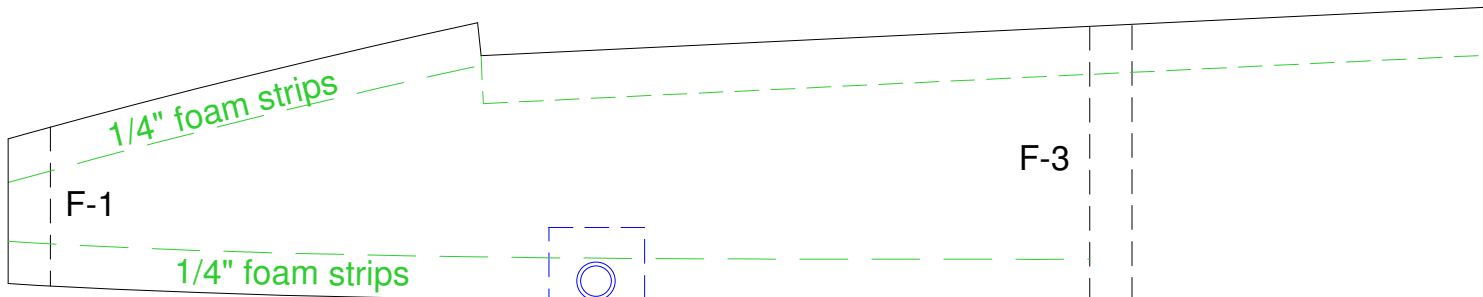

1/4" foam strips

1/2" + 1/4" foam strips

Fuselage sides  
Make 2

F-4

1/4" balsa triangle stock on bottom

inlet bottom  
Make 1

Aft fuselage top  
Make 1

Drill 3/16"

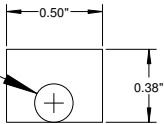

Canard pivot reinforcement  
Make 2 from 1/32" ply

Wing strake  
Make 2 from 1/32" ply

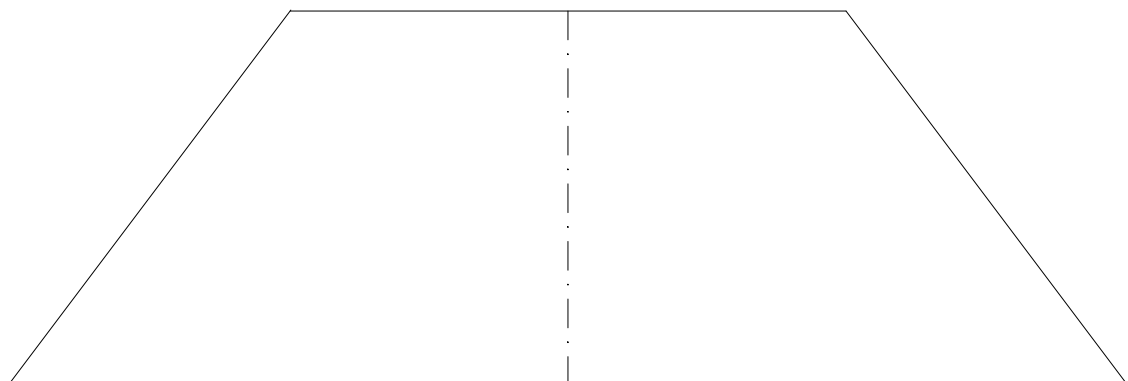

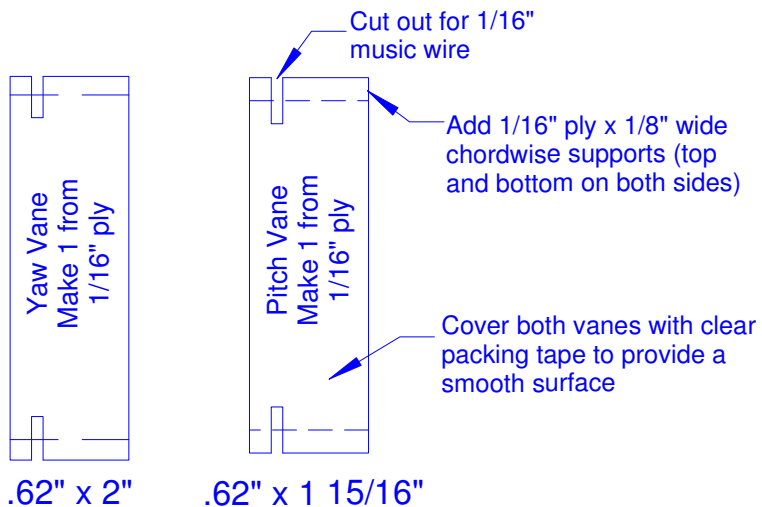
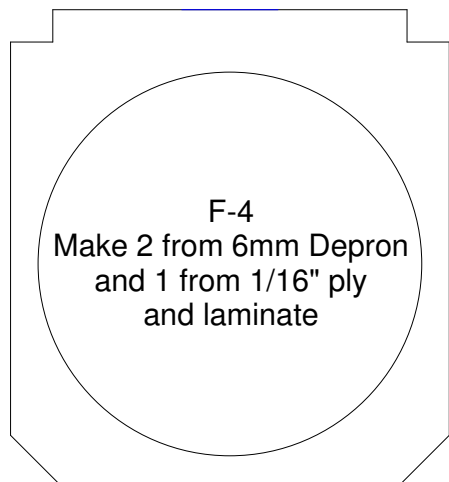
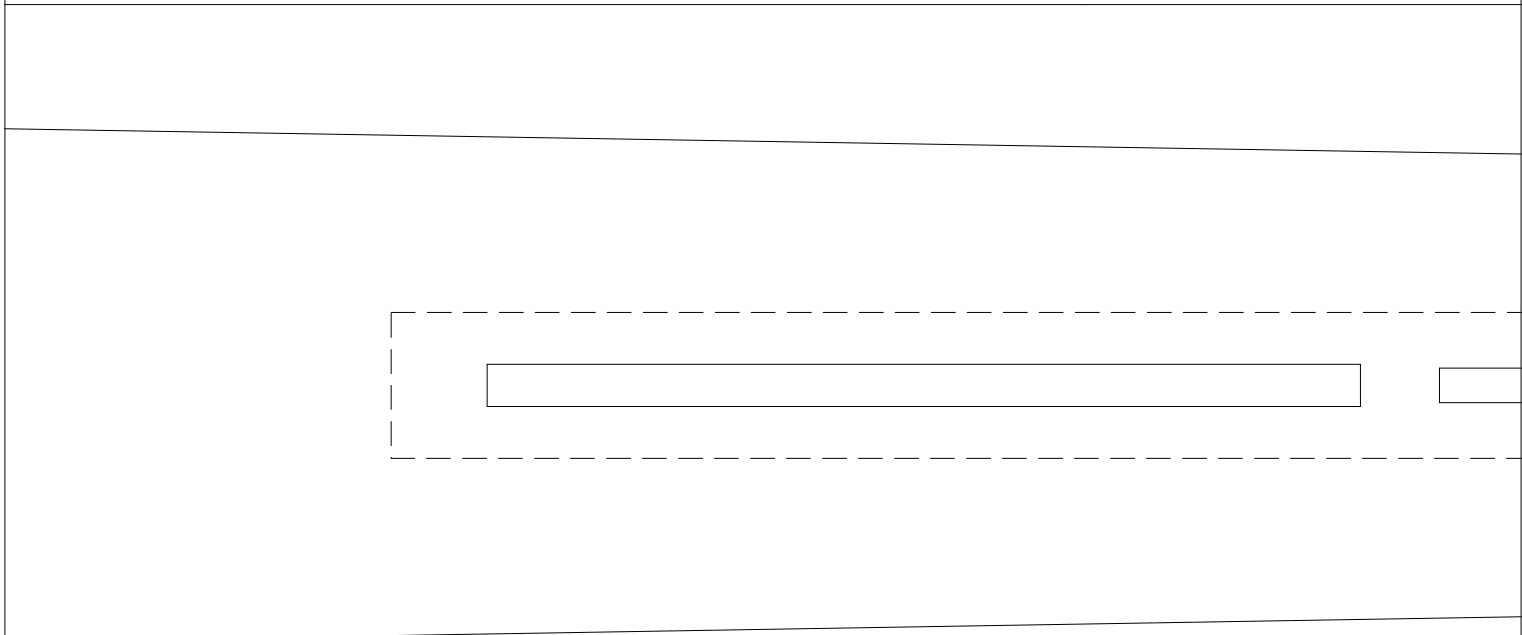
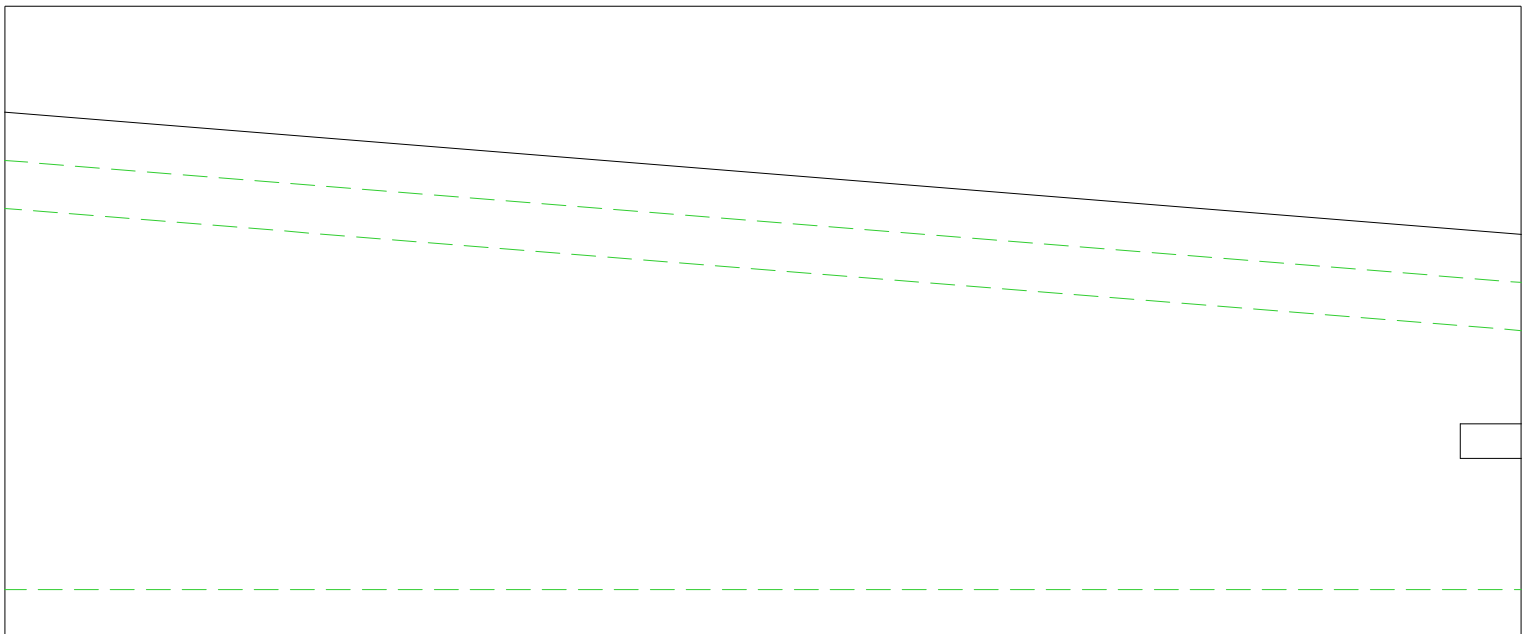



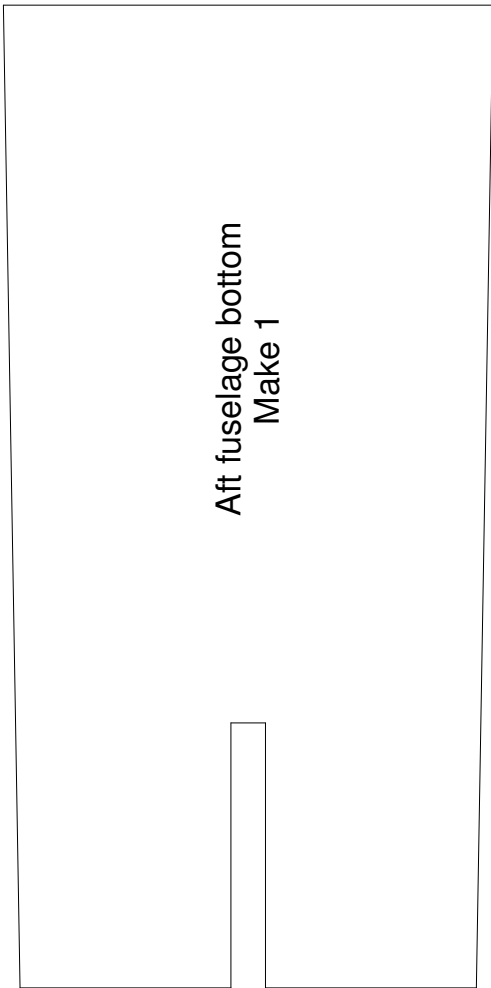
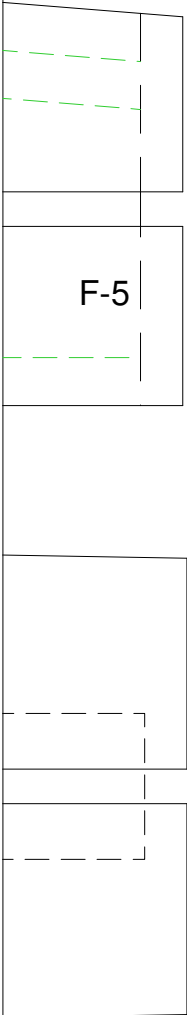

Aft fuselage bottom  
Make 1

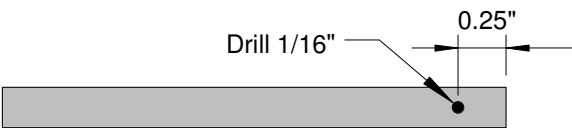

Yaw vane support  
2.62" x .21" dia carbon tube

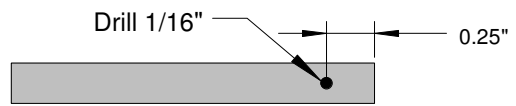

Pitch vane support  
1.87" x .21" dia carbon tube

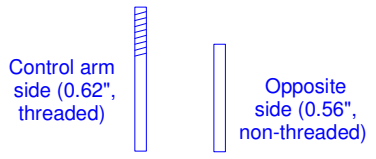

Vane pivots  
Make 2 each from  
1/16" music wire

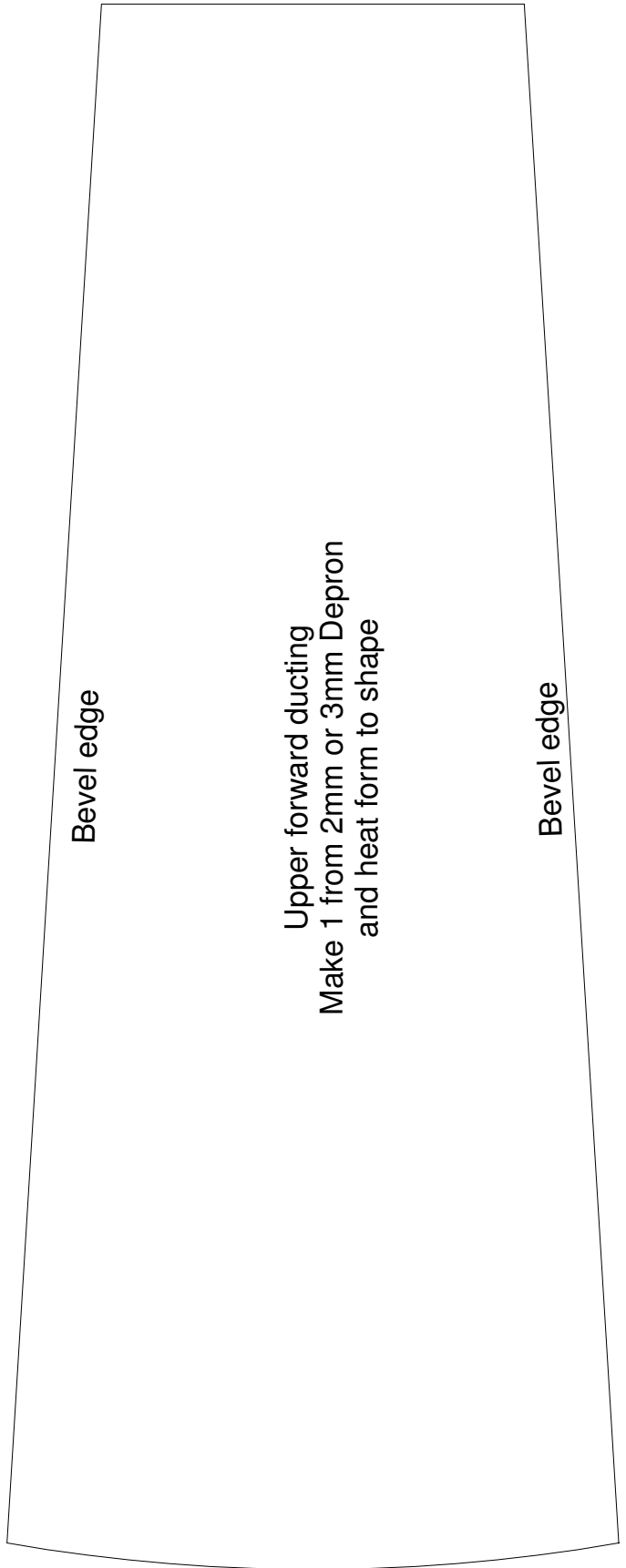

Upper forward ducting  
Make 1 from 2mm or 3mm Depron  
and heat form to shape

Bevel edge

Bevel edge

Thrust tube  
Make 1 from overhead  
transparency material  
and roll into a tube

