

CANOPY TEMPLATE

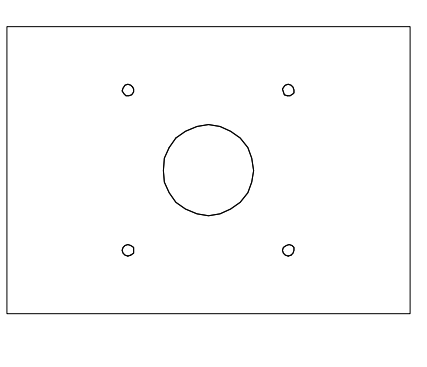

FIREWALL 1/8" PLY - 1 REQ.

OPTIONAL SPAR POCKET FOR 3MM CF OR 1/8" WOOD DOWEL

KF STEP PANEL - 1 REQ.

HORIZONTAL TAIL ASSEMBLY - 1 REQ.

3.0000

CENTER OF GRAVITY

OPTIONAL SPAR POCKET FOR 3MM CF OR 1/8" WOOD DOWEL

MAIN WING PANEL - 1 REQ.

NOTE:
USE OF OPTIONAL SPAR POCKET

THIS OPTION IS TO BE USED IN PLACE OF STRAPPING TAPE ON THE OUTSIDE OF THE WING. YOU MAY USE CARBON FIBER OR 1/8" WOOD DOWEL ROD. IF USING CF YOU ONLY NEED THE POCKET IN THE MAIN WING PANEL. YOU CAN OPT FOR THE LOWER COST MATERIAL OF WOOD DOWEL ROD. IN THIS CASE USE BOTH POCKETS ON THE MAIN WING AND KF PANELS. PLACING DOWEL ROD IN BOTH, THEY ARE ONE OVER THE OTHER AND WILL PROVIDE MORE THAN ADEQUATE STRENGTH.

29.60

RUDDER PANEL - 1 REQ.

EQUIPMENT SPECIFICATIONS:

MOTOR: BLUE WONDER 1700 KV

SERVOS: HXT 9G (2)

BATTERY: 900 MAH 2S

MATERIAL SPECIFICATIONS:

ALL MATERIAL IS DOW PROTECTION BOARD III UNLESS OTHERWISE SPEC'D

FUSELAGE CENTER PANEL - 1 REQ.

RH FUSELAGE OUTER PANEL - 1 REQ.

LH FUSELAGE OUTER PANEL - 1 REQ.

FUSELAGE INTERMEDIATE PANEL - 2 REQ.

FUSELAGE RX COVER - 1 REQ.

FUSELAGE BATTERY COVER - 1 REQ.

FUSELAGE ESC/SERVO COVER - 1 REQ.

ALIGNMENT PIN HOLES - USE IF DESIRED SIZED FOR BAMBOO SKEWER MATERIAL FOR KEEPING PANELS ALIGNED WHILE GLUEING

P-51D MUSTANG SEMFF COMBAT PLANE

DESIGNED BY DZ1SFB ON RCGROUPS.COM
FOR NON COMMERCIAL USE ONLY
RELEASED 18-APR-2010