



**August 19, 2018**

Hosted by  
**Thousand Oaks Soaring Society**  
at **SAPWI TRAILS PARK, THOUSAND OAKS, CA**

<https://www.google.com/maps/@34.2084662,-118.8311066,626m/data=!3m1!1e3>

**Registration Opens at 8:00 AM**  
**Pilot's Meeting at 9:00 AM**  
**First Flight at 9:15 AM**

**Contest Director: Mike Reagan / Assistant CD: Gary Filice**

**4 Rounds Precision Duration**  
**8 Minute**  
**8 Minute**  
**10 Minute**  
**10 Minute**  
**25 Foot Tape Landing**

**Tearing Carpet with a Skeg Results in Zero Flight Score.**

**950 flight points and 50 landing points per round**  
**Winches with retrievers, approximately 600' to turnarounds**  
**5400 square foot carpet landing zone**  
**Restroom facilities on site**

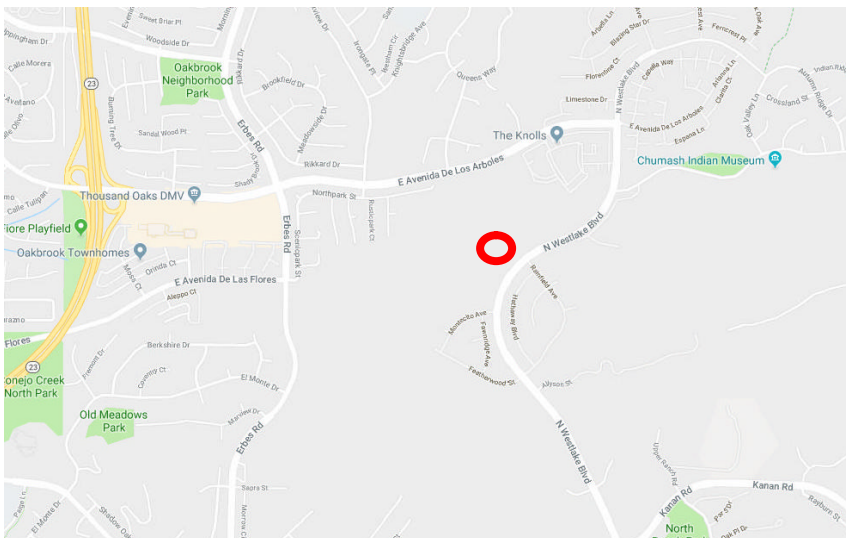

***Carpet Friendly***  
***Landing Devices Only!***

**NO-Fly Zones:** 1) East of West Lake Blvd,  
2) Houses on the south side of the field.

**The field address is:** Sapwi Trails Community Park, Westlake Blvd, Thousand Oaks 91362. Gate opposite Rainfield Ave. **No left turn into park** from Westlake Blvd. When thru gate, turn left and go UP the hill. **Right turn only when leaving the park.**

Please park in the parking lot on the south side of the field.

The field will be open at 7:30 AM and the winches will be set up by 8:00 for practice or fun flying. The winches will be shut down at 8:45.

See [www.tosoaring.com](http://www.tosoaring.com) for more info.

Gate Location: 34.2081512,-118.8323833 **opposite Rainfield Ave.**

**DIRECTIONS:** Rt 101 to Westlake Blvd, North on Westlake Blvd, U-Turn at Lang Ranch Parkway, Right into Gate, Left at T-Intersection.

Or  
Rt 101 to Rt 23 North. Exit Avenida De Los Arboles, Right at bottom of exit. Right on West Lake Blvd at T intersection. Right at park gate.

Mike Reagan 805.990.1602

# THOUSAND OAKS SOARING SOCIETY - SAPWI TRAILS COMMUNITY PARK

## NO FLY ZONE



- NO FLY ZONE (ALL ALTITUDES):**
- 1) OVER WESTLAKE BLVD)
  - 2) ANY WHERE EAST OF WESTLAKE BLVD
  - 3) ALL HOUSES TO THE SOUTH OF THE FIELD