

balsa,
5 mm

plywood,
3 mm

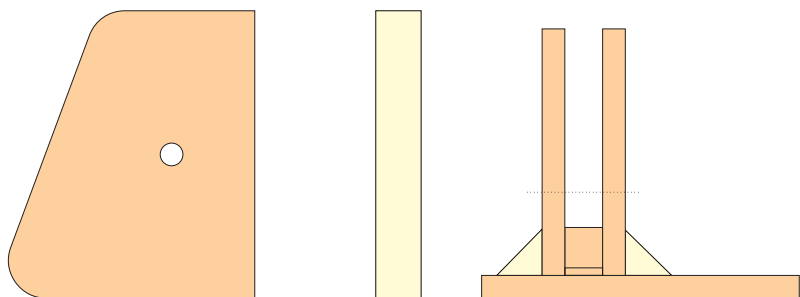
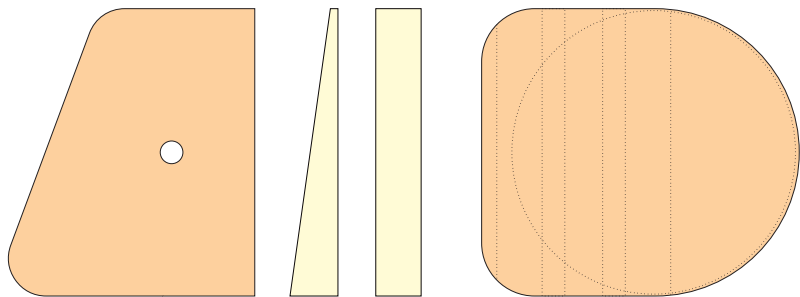

plywood,
3 mm

balsa,
6 mm x 6 mm

motor mount

200 mm

8"

front wheel suspension

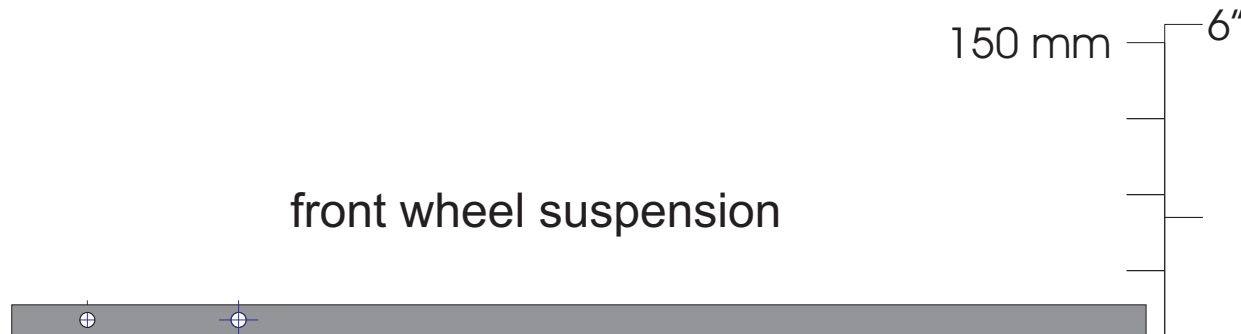

150 mm 6"

cf rod, O.D. 4 mm



100 mm 4"

cf sheet, 1 mm

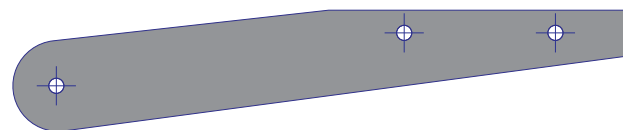

beech wood, 5 mm x 6 mm



cf tube, 6 mm x 6 mm, I.D. 4 mm



beech wood, 5 mm x 6 mm



cf sheet 1 mm

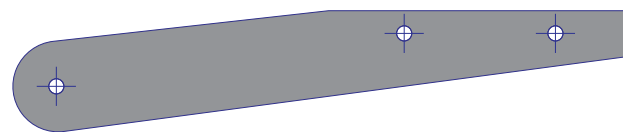

100 mm

4"

0