

**Quiet & Electric  
Flight** International

**MW3136  
Pushy Cat**

Designed by Ron Loden

A 36" span twin-boom electric sports model for a single  
400 size brushless motor and 3-function micro radio

© Triplet Publications Limited

A 36" TWIN BOOM SPORTS MODEL FOR  
400 SIZE BRUSHLESS MOTORS &  
WITH MICRO RADIO ON 10CELLS/LIPO'S

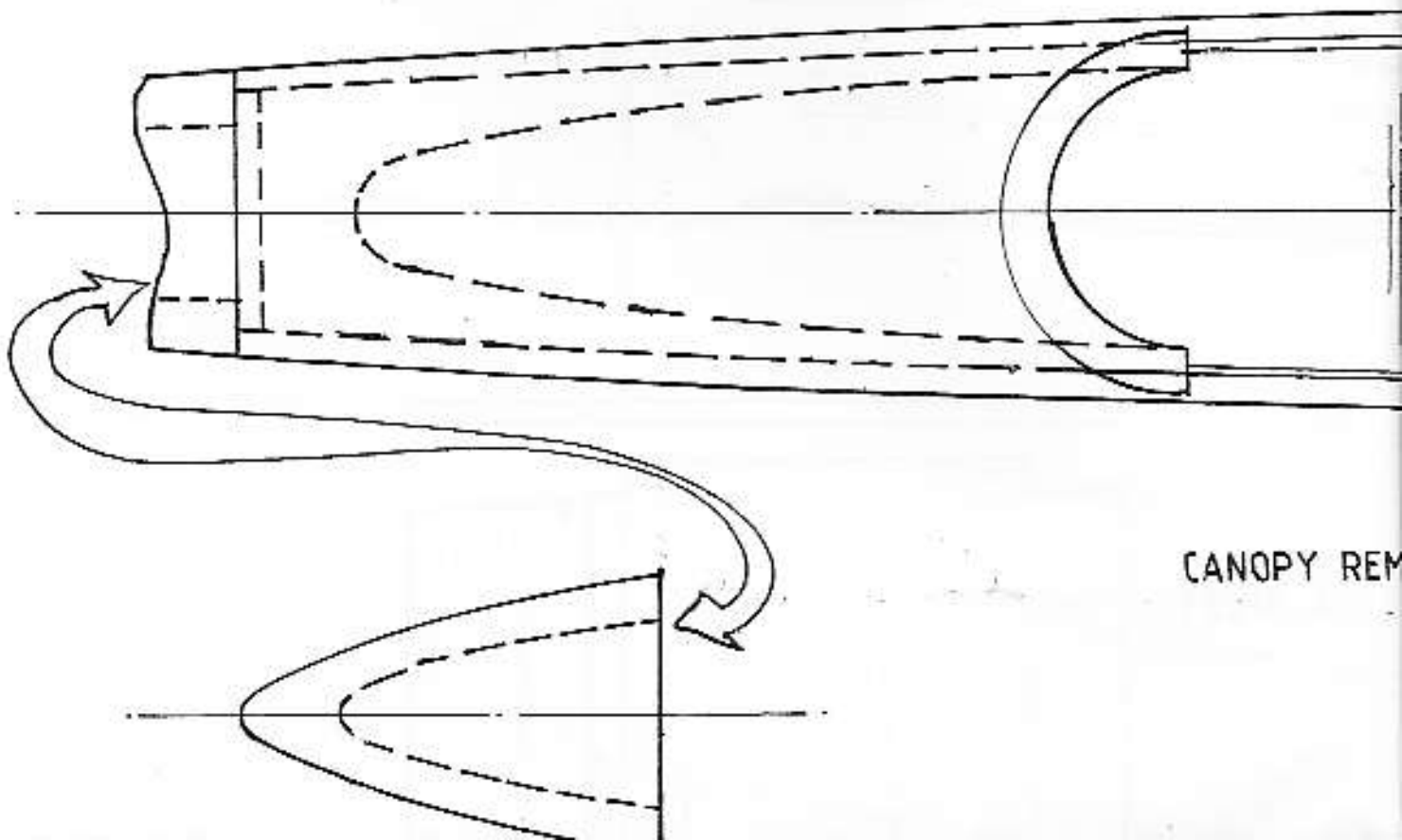

CANOPY REM

APLET PUBLICATIONS LTD.  
I. 01684 588500

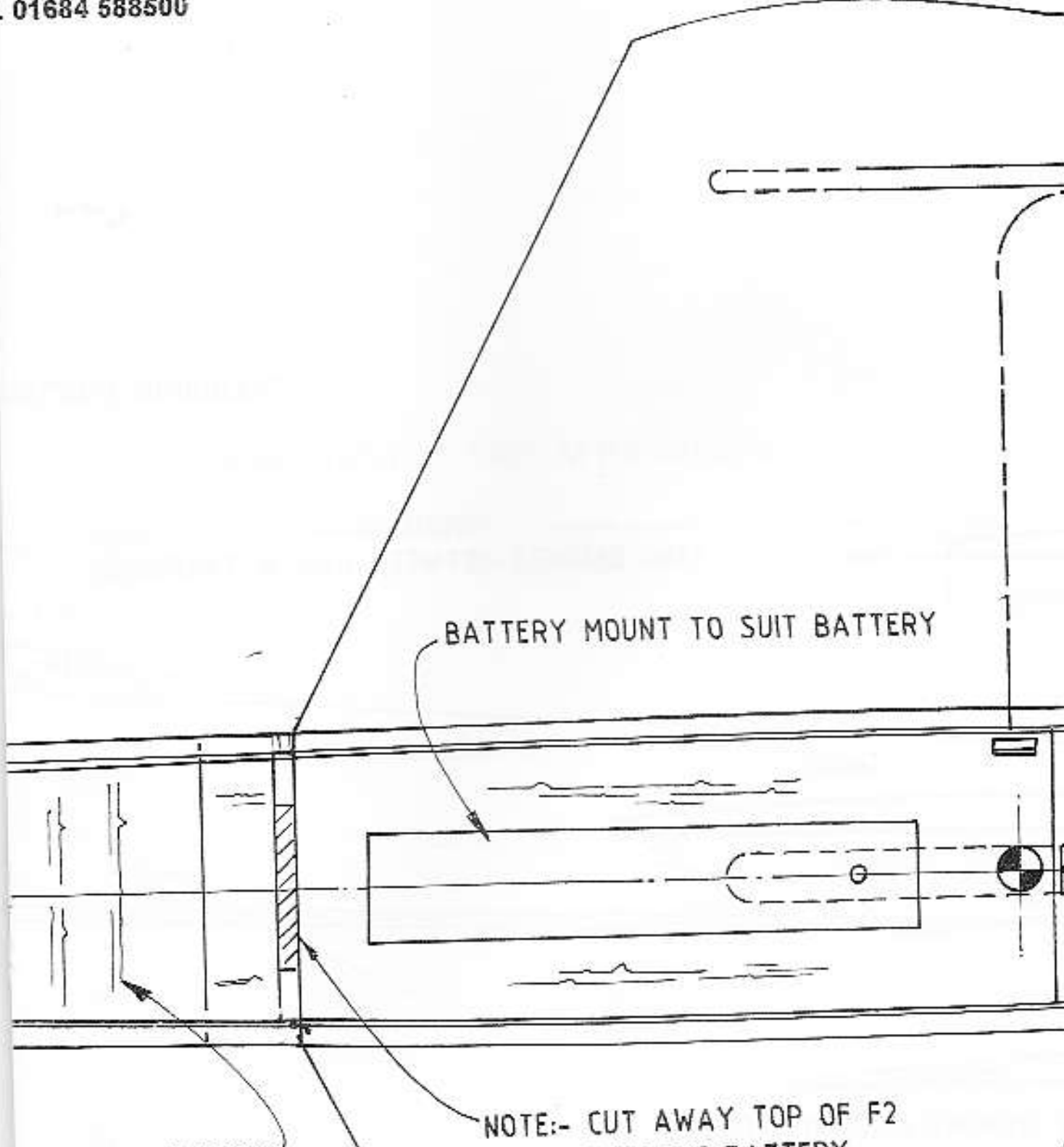

BATTERY MOUNT TO SUIT BATTERY

MOVED FOR CLARITY

NOTE:- CUT AWAY TOP OF F2  
TO ACCOMODATE BATTERY  
AS RE

1/4"

TRACK OF SERVO LEAD  
- GLUE FLAT TO UNDERSIDE

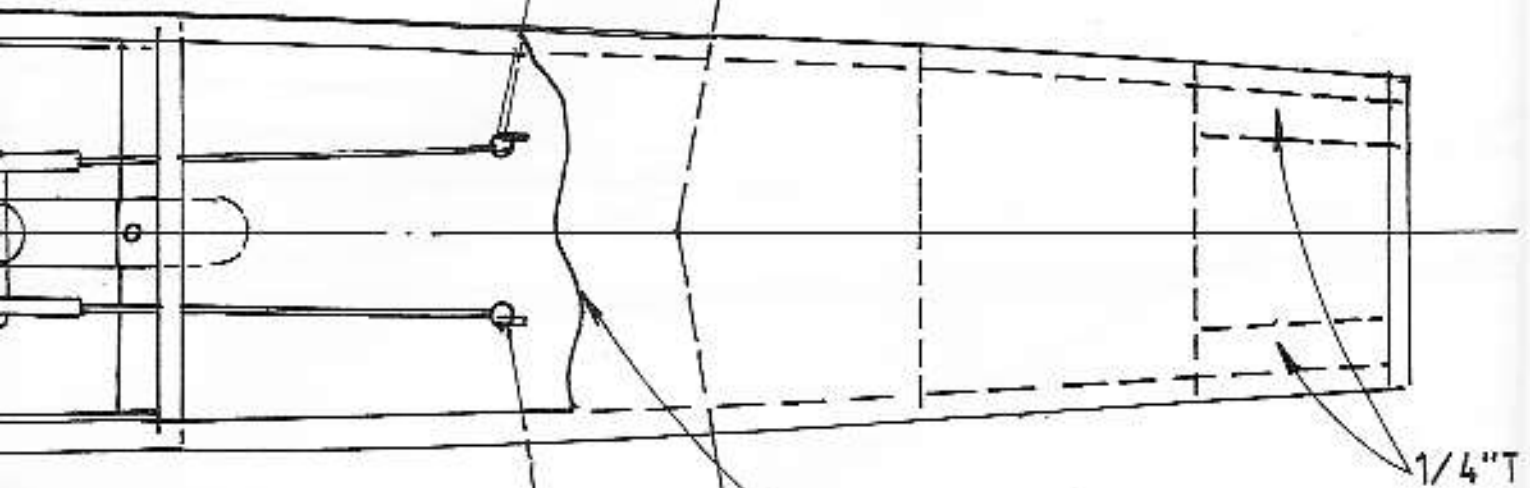

□ BALSA SERVO RAILS

REAR UPPER SHEETING  
CUT AWAY FOR CLARITY

1/4" T

SERVO FIXED TO UNDERSIDE  
OF TAILPLANE WITH SERVO  
TAPE

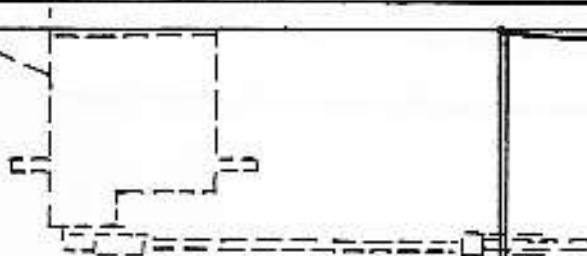

TRIANGLE SECTION CORNERS

F1 1/8" Balsa

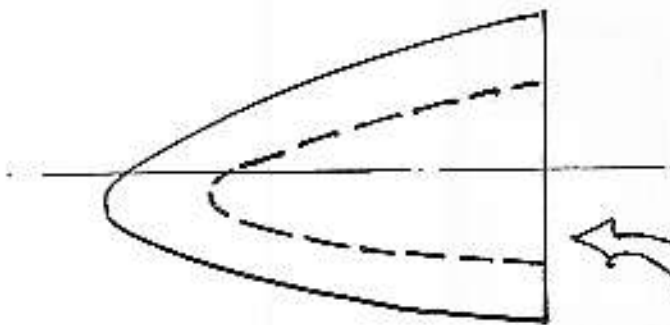
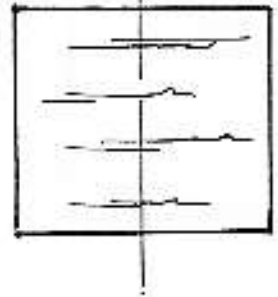

CARVE & HOLLOW OUT NOSE SECTION

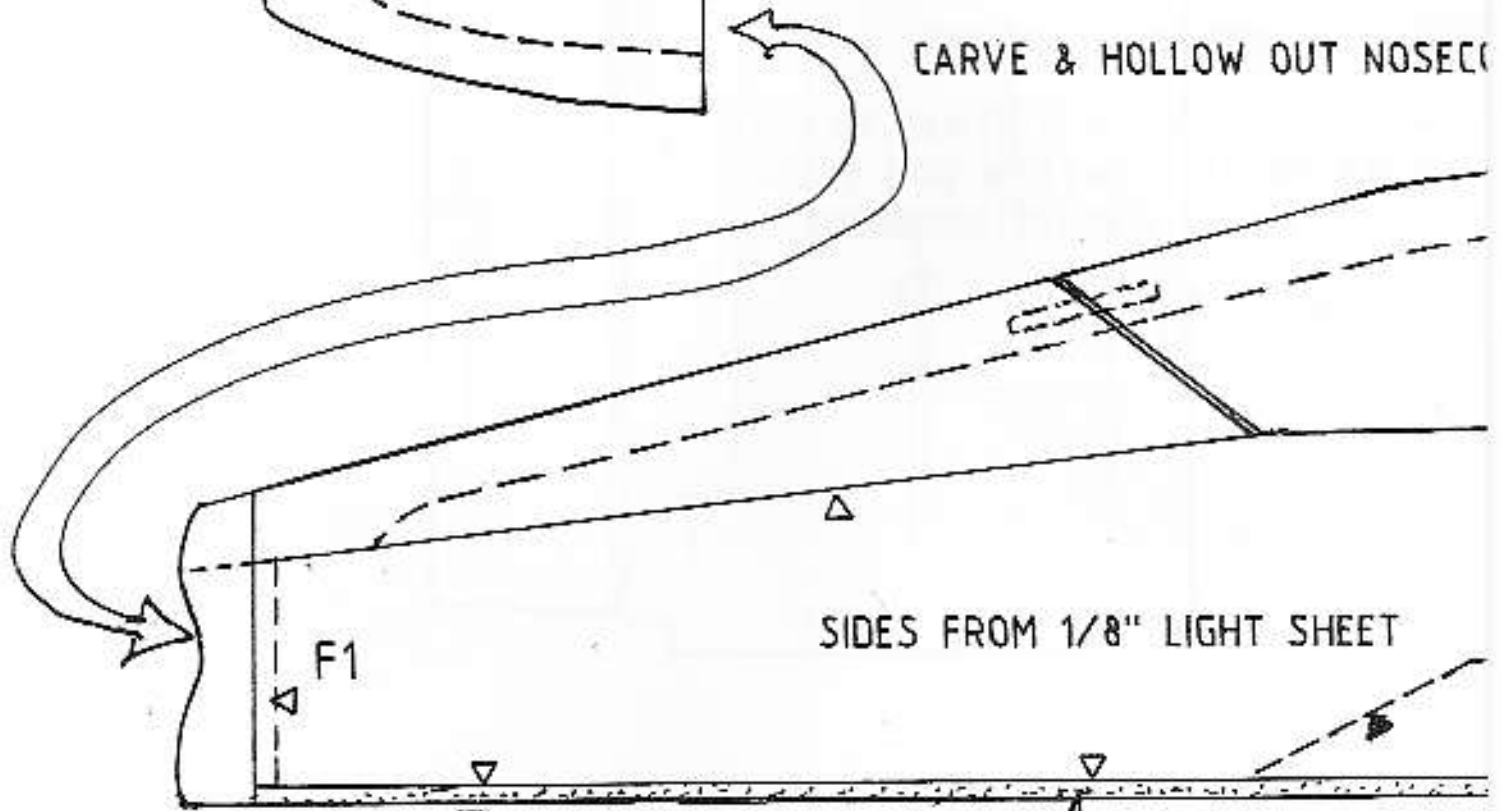

SIDES FROM 1/8" LIGHT SHEET

MEDIUM 1/8" Balsa SHEET  
(GRAIN CROSSWAYS)

F2 1/8" (3mm) LITEPLY  
SEE NOTE

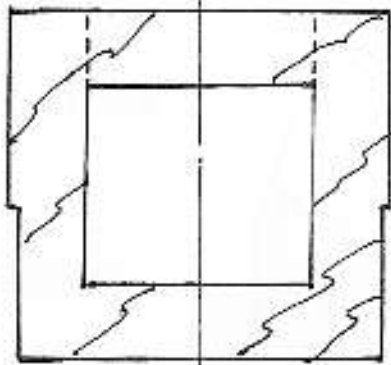

△ INDICATES FUSELAGE SIDES  
▲ INDICATES PLY DOUBLERS

LINE

HOLLOWED OUT SOFT Balsa CANOPY

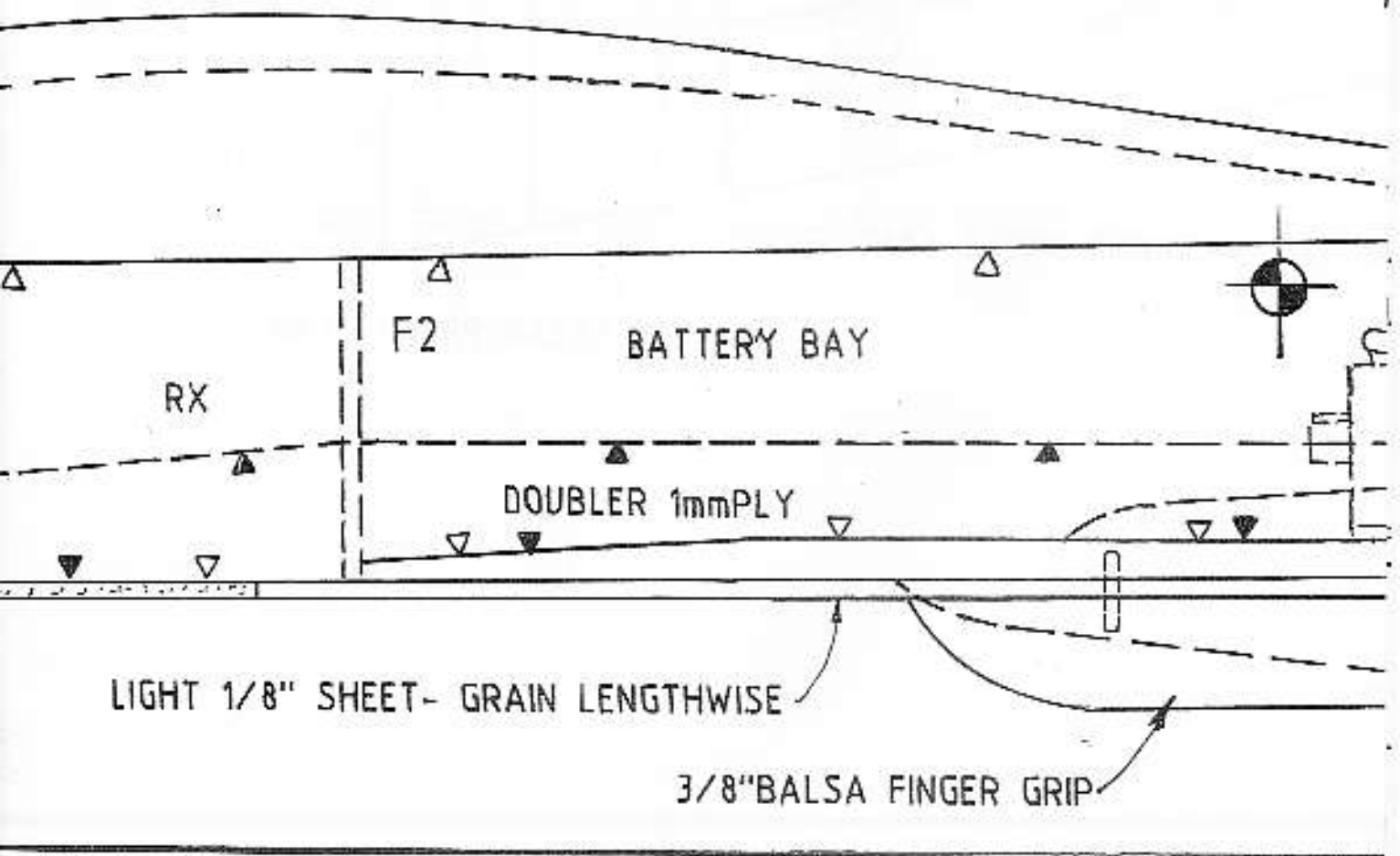

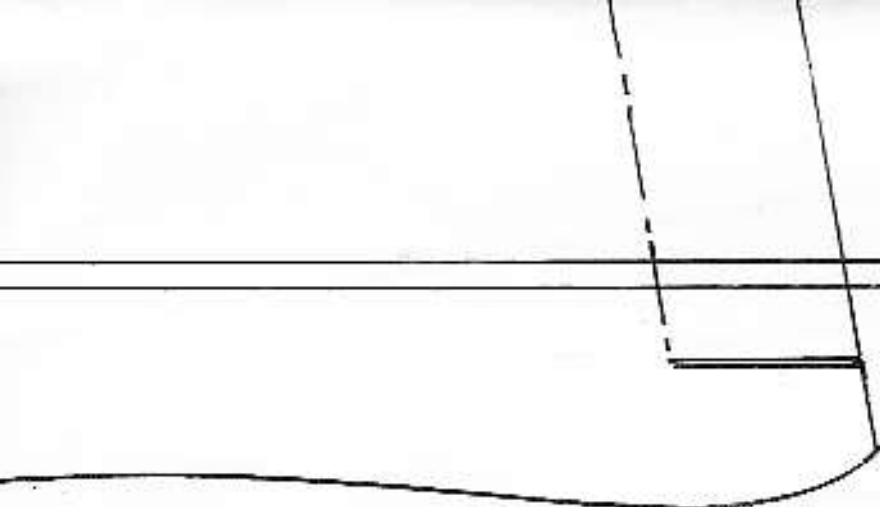

F4 2-3

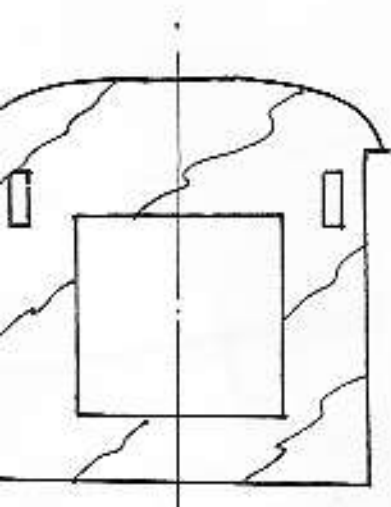

HOLES FOR CTRL. BATTERY LEADS  
(SIZE TO SUIT)

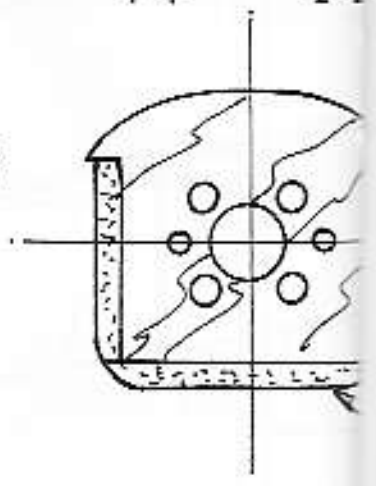

F3 1/8" (3mm) LITEPLY

CONTROLLER FIXED WITH VELCRO

3/8" SOFT BALS

INDICATES TRACK  
GLUE FLAT TO  
BOOMS

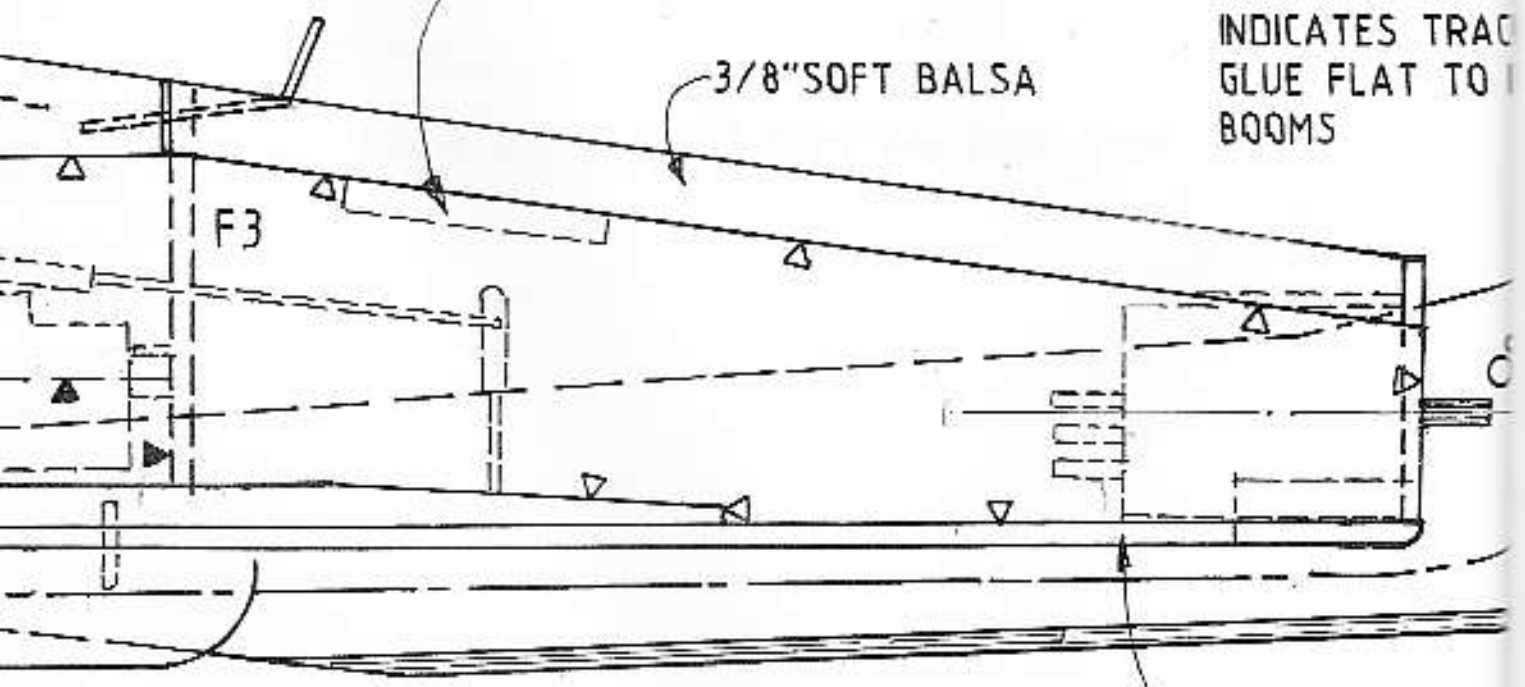

F3

MOTOR ACCESS

mm PLY

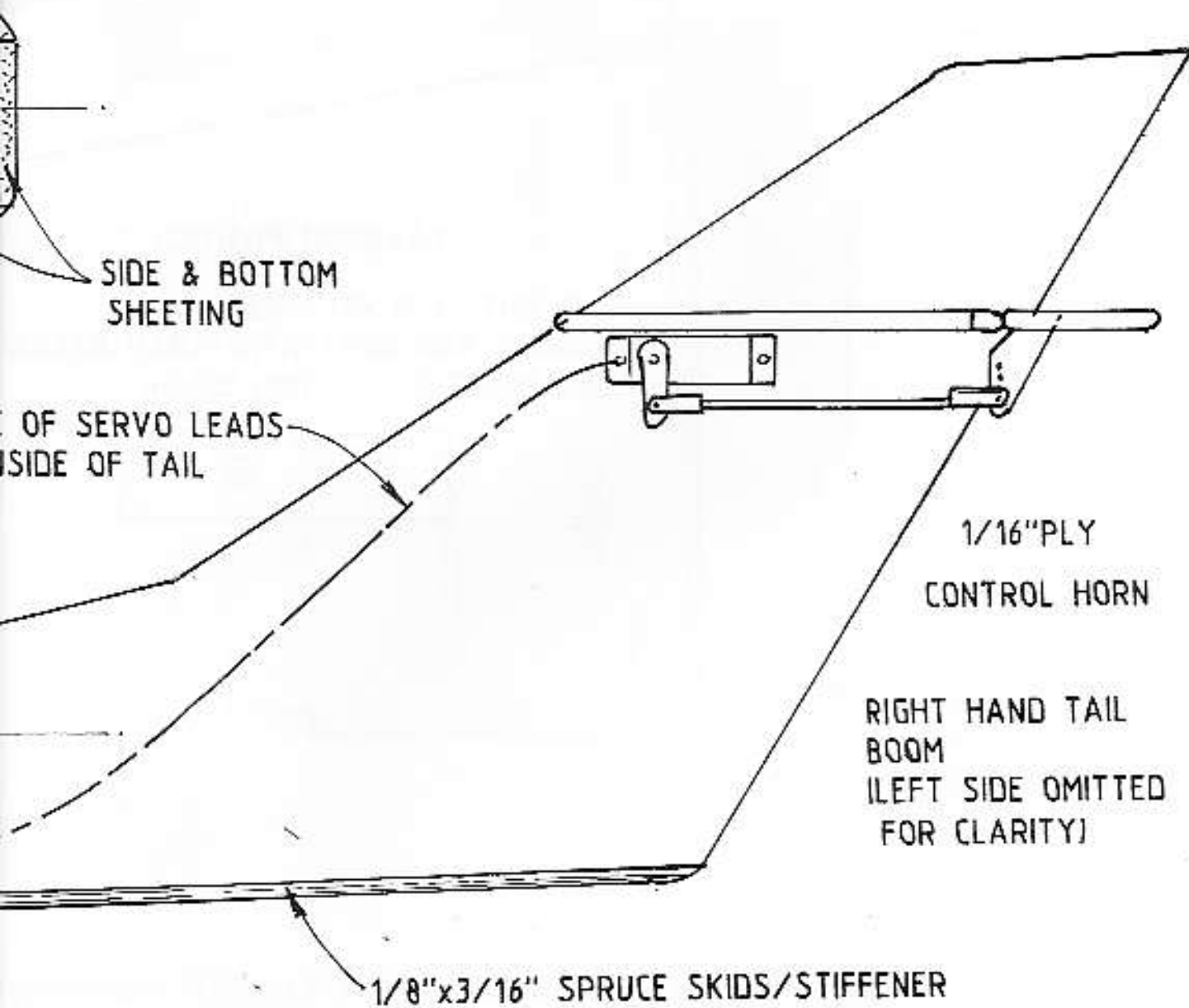

SIDE & BOTTOM SHEETING

OF SERVO LEADS  
INSIDE OF TAIL

1/16" PLY  
CONTROL HORN

RIGHT HAND TAIL  
BOOM  
(LEFT SIDE OMITTED  
FOR CLARITY)

1/8"x3/16" SPRUCE SKIDS/STIFFENER



**Quiet & Electric  
Flight** International

**MW3136  
Pushy Cat**

Designed by Ron Laden

A 36" span twin-boom electric sports model for a single  
400 size brushless motor and 3-function micro radio

© Trolet Publications Limited

100mm  
WING PANELS

REMOVE AFTER SANDING

3mm

52mm

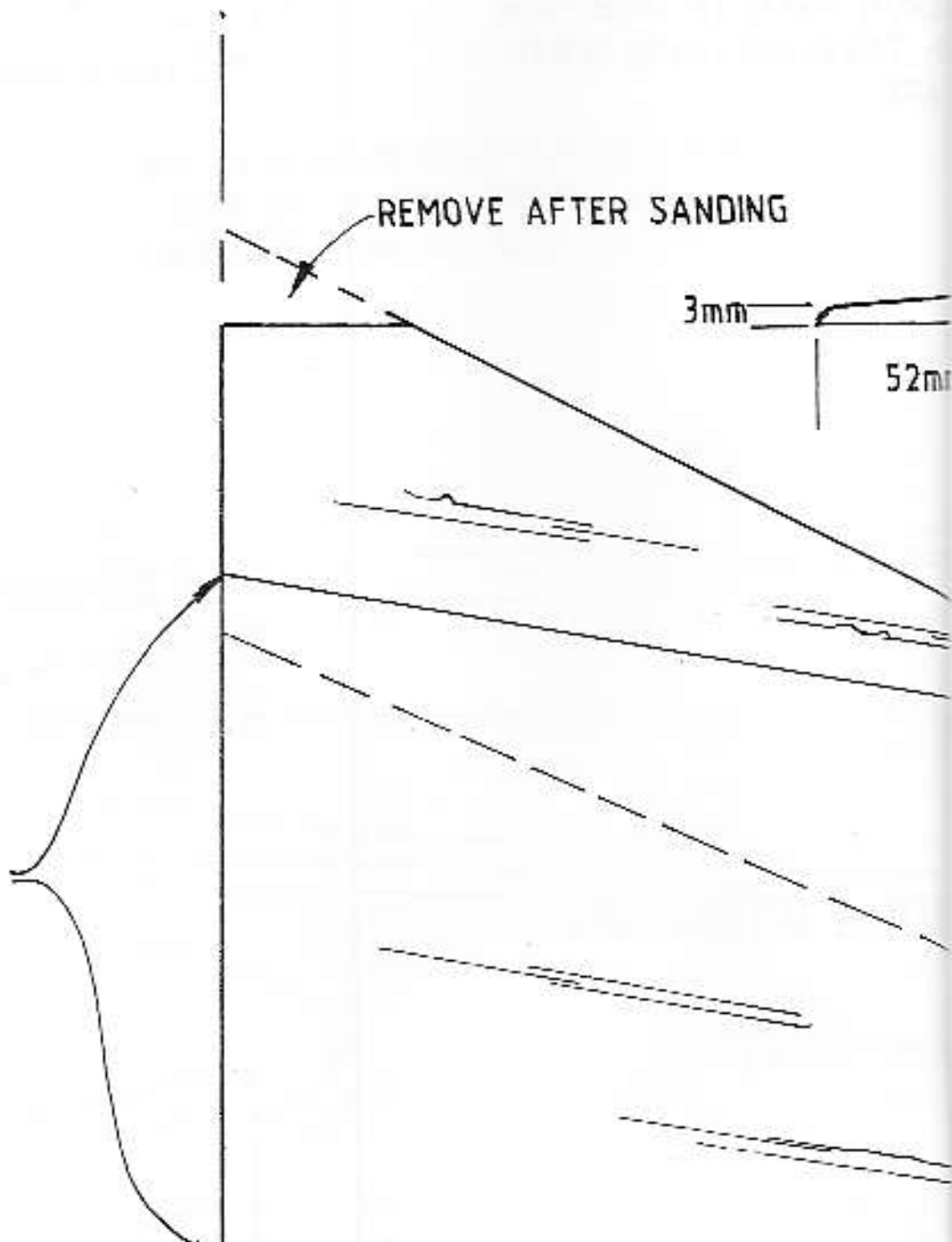

WING PROFILE AT ROOT AFTER SANDING

T/E

58mm L

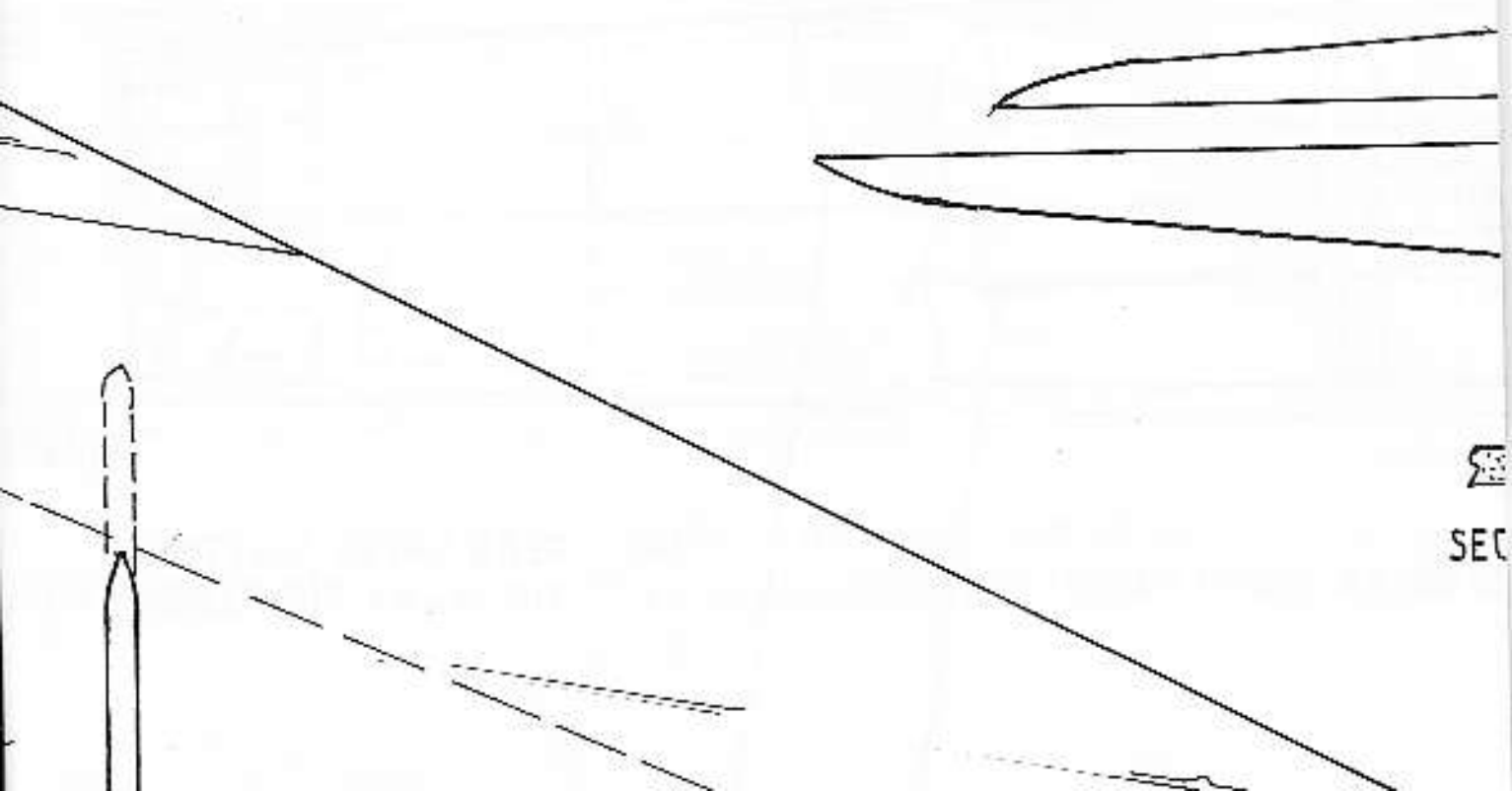

SEC

TAILBOOMS 3/16" LIGHT

"INCIDENCE"  
ZERO DEGREES BETWEEN WING & TAILPLANE

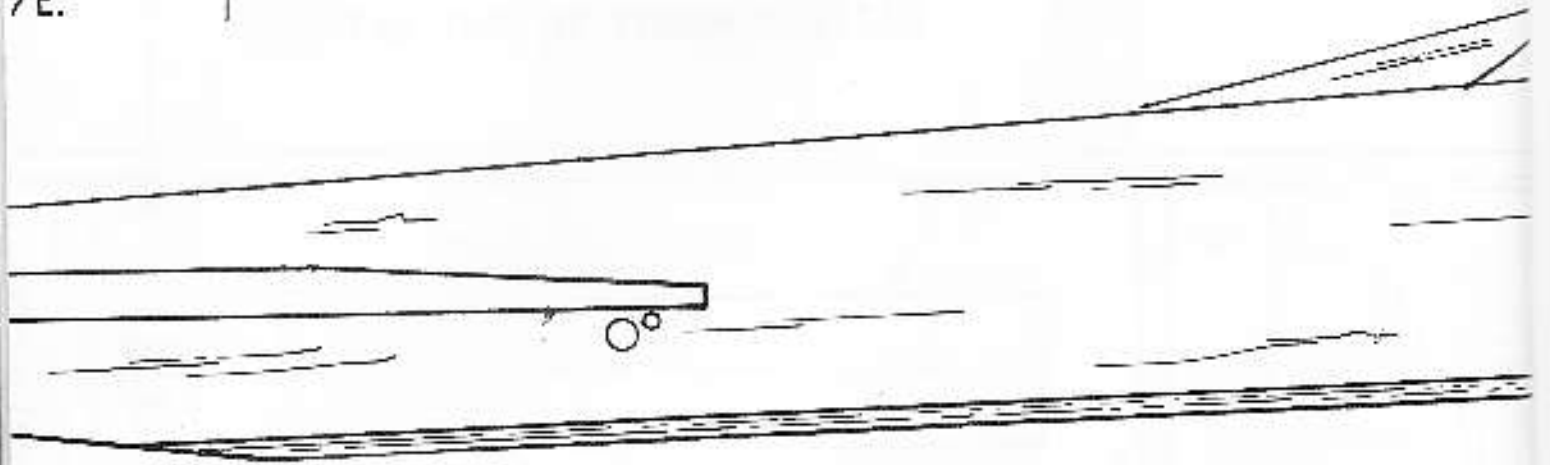
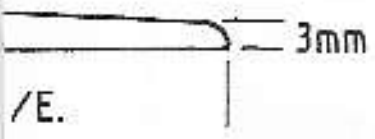

...TION SHOWING AILERON HINGE

TAILPLANE 1/8" LIGHT

IT SHEET  
2off

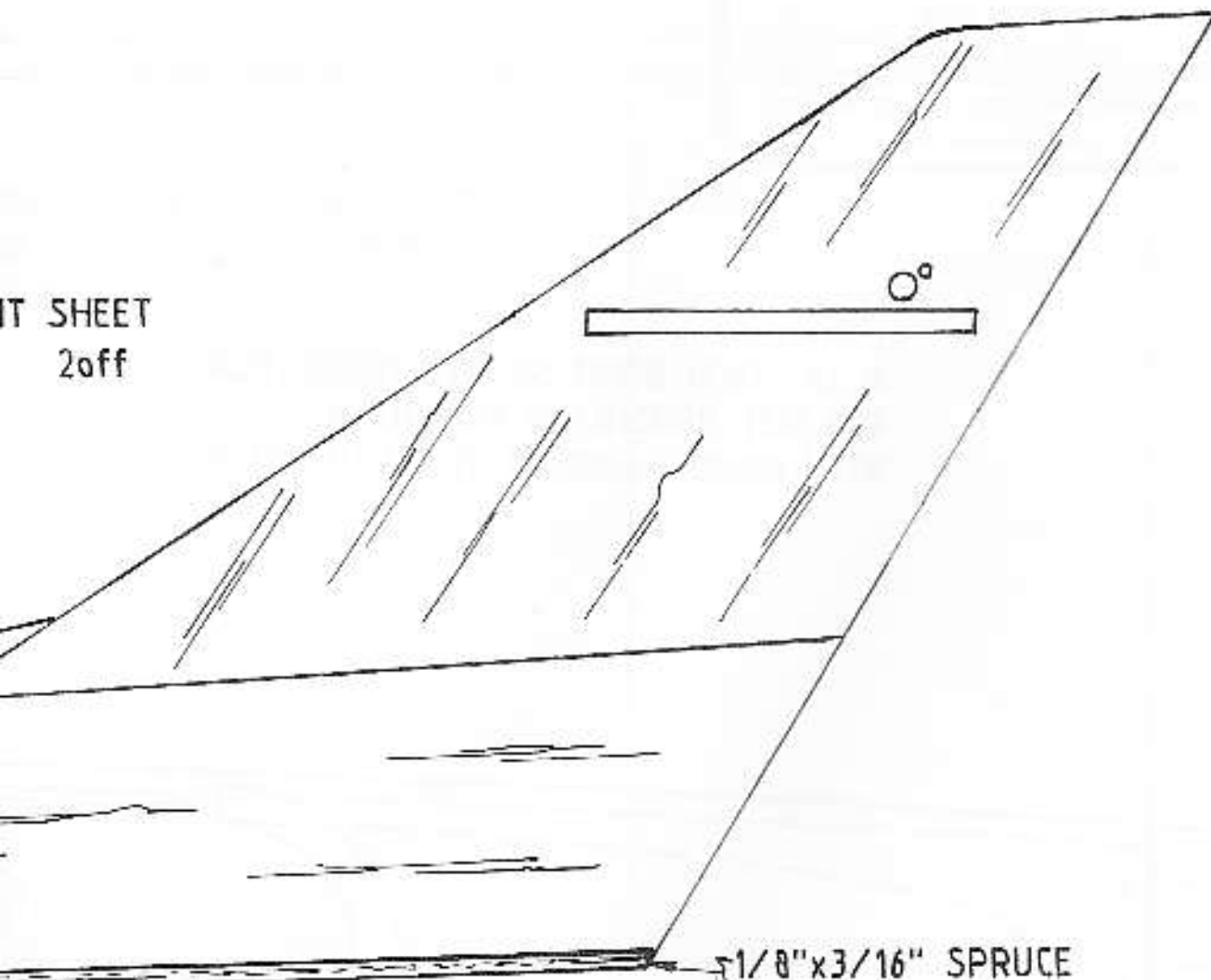

1/8" x 3/16" SPRUCE

BALSA SHEET

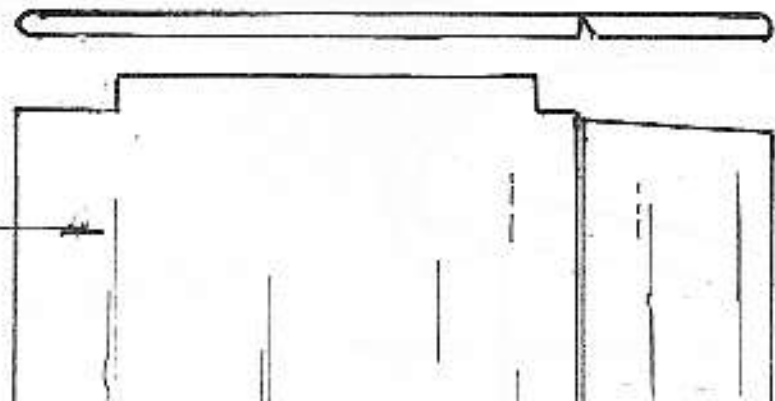

TOP VIEW STARBOARD WING

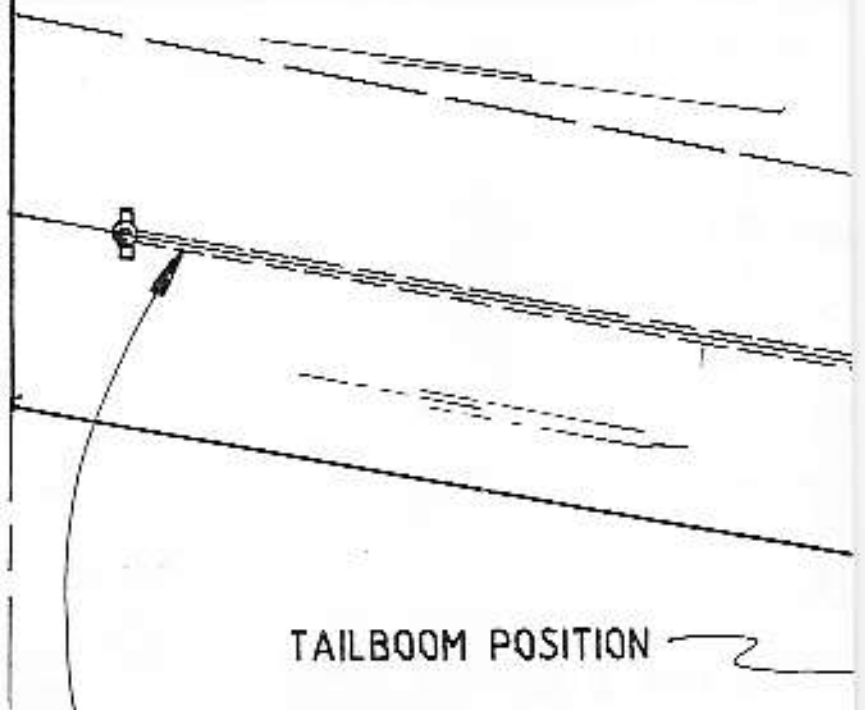

TAILBOOM POSITION

CUT OUT SLOT TO HOLD  
TORQUE ROD INFILL WITH SCRAP Balsa  
SEE ENLARGED SECTION BELOW

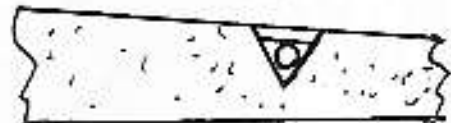

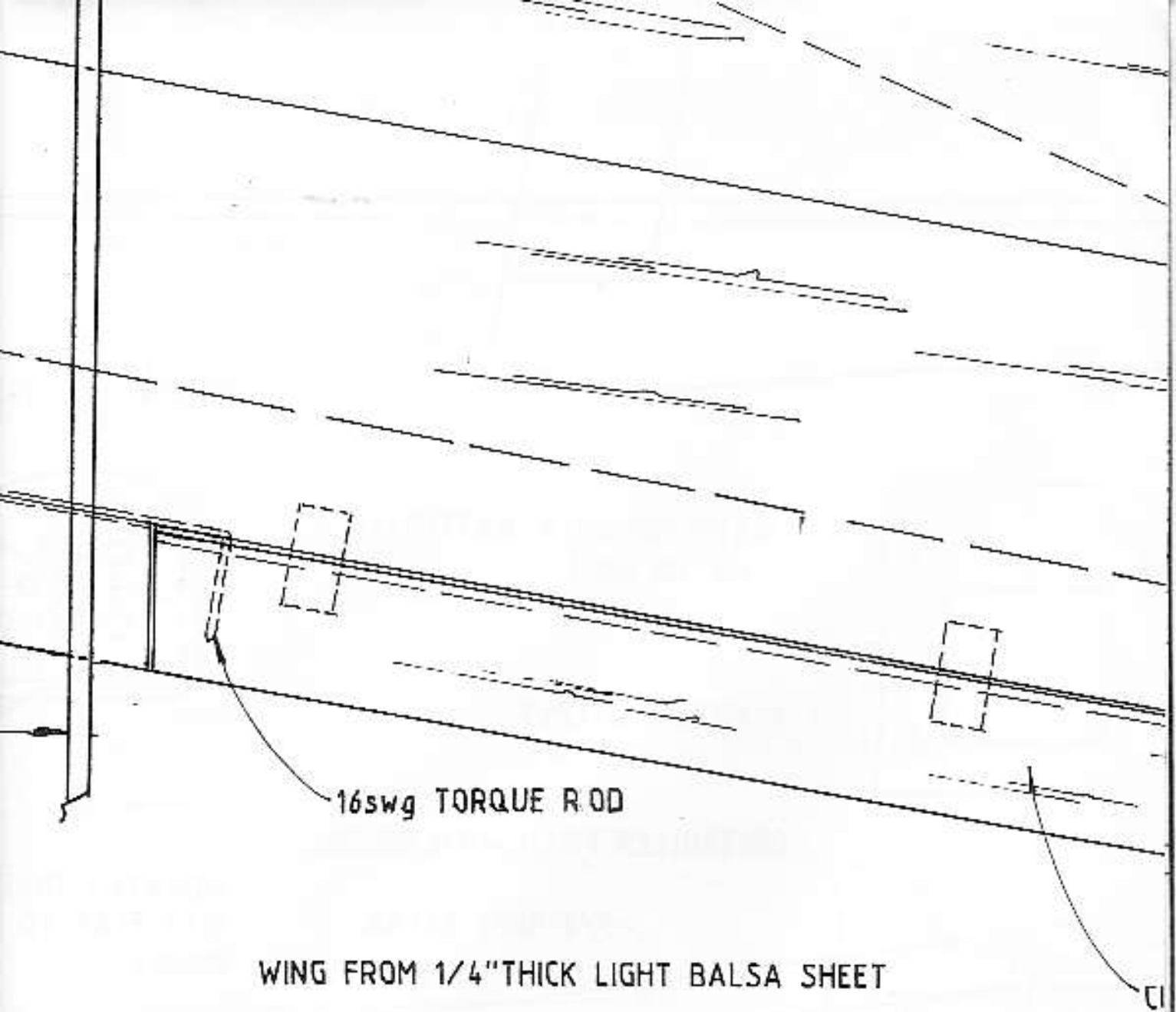

16swg TORQUE ROD

WING FROM 1/4" THICK LIGHT BALSA SHEET

CL

CONTROL THROWS:-

ELEVATOR 6mm

AILERON 6mm

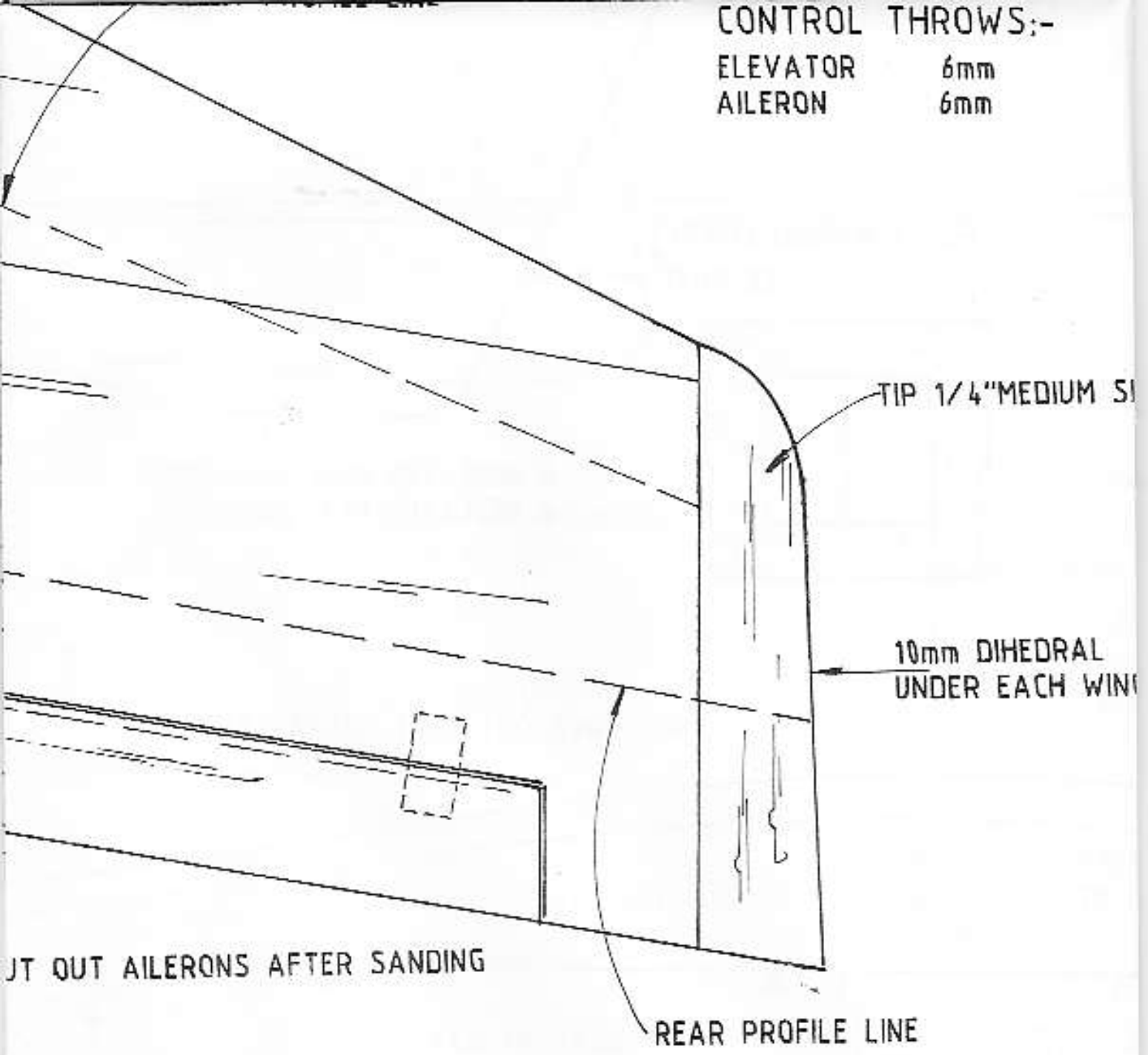

TIP 1/4" MEDIUM SAND

10mm DIHEDRAL  
UNDER EACH WING

CUT OUT AILERONS AFTER SANDING

REAR PROFILE LINE

HEET

TIP

